

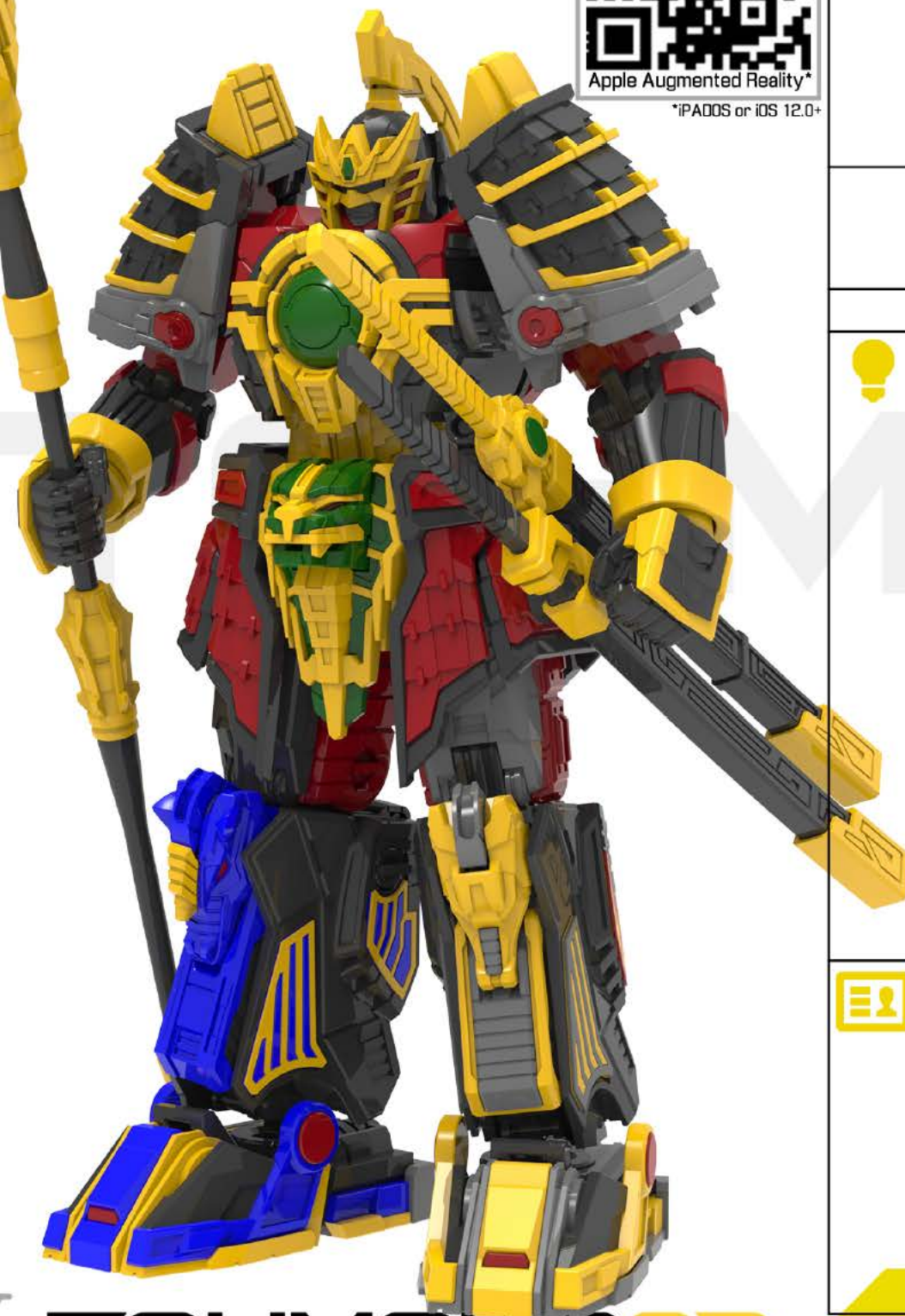

*iPADOS or iOS 12.0+



Contains small parts and requires high precision. Your printer may need to be properly calibrated for best results. (Tolerances: Peg 0.15mm, Balljoint 0mm, Slide 0.3mm, Screws 0.4mm)



Settings:

Minimum printer size: 200mmX200mmX200mm
Support : NO
Nozzle: 0.4mm
Layer: 0.15mm, head & small parts 0.1mm
Filament: PLA
Temperature: 205°C
Speed: 40mm/s (normal), 100mm/s(fast)
Skin/top/bottom: 0.8/0.8/0.8 mm
Infill: 20-25% (50% for screws)

Height : 360 mm / 14.1 inches

Total : 204 Parts, 1.970 grams

- Pine Green : 10 Parts, 60 grams
- Silver : 30 Parts, 160 grams
- Red : 48 Parts, 200 grams
- Gold : 80 Parts, 240 grams
- Blue : 11 Parts, 60 grams
- Black : 125 Parts, 1.250 grams
*with all accessories & 13 hands

Biggest Part : 2a [78mm W X 66mm L X 76mm H]

Tallest Part : 7aL,7aR [60mm W X 70mm L X 105mm H]

Widest Part : 10c,9c [190mm W X 185mm L X 2mm H]

Tools: Cutter, Sand Paper, Super Glue, Nail Polish



Tips & Tricks:

Print result isn't smooth enough and parts aren't fit properly:

- Calibrate your printer properly
- Make sure you print it in right temperature
- If you print it too fast, it may cause ghosting on the surface of the object
- Decrease the layer height (0.15mm for small figure and 1 mm for the head/face)

Object won't stick to the print bed:

- Setup your bed leveling properly
- Use brim for small objects which have small contact to the bed
- Increase first layer extrusion to 125%-150%
- If you are using Buildtak, sand the surface using sand paper
- Set the printing speed of the first layer to 20 m/s

How to fix loose ball joint?

- Material Shrinkage: PLA 0.2%, ABS 0.8%
- Use clear nail polish. Use it on both female and male ball joint section or on friction joint surfaces. Wait until it dry before put them back in place
- If the ball joint is loose right after printing, It may cause by under extrusion. Increase filament flow rate by 110% - 125%

Finishing touch

- Use cutter or sand paper for peg adjustment
- Use super glue to assemble the part
- Spray the finishing object using clear coat to protect the object from the weather for long term use.



BY BUYING THIS PRODUCT YOU AGREE TO THESE TERMS:

LISENCE: Attribution-NonCommercial-NoDerivatives 4.0 International (CC BY-NC-ND 4.0)

1. **ATTRIBUTION:** You must give appropriate credit, provide a link to the license, and indicate if changes were made. You may do so in any reasonable manner, but not in any way that suggests the licensor endorses you or your use.
2. **NONCOMMERCIAL:** You may not use the material for commercial purposes.
3. **NO DERIVATIVES:** If you remix, transform, or build upon the material, you may not distribute the modified material.

ADDITIONAL RESTRICTION — You are not allowed to share these FILES on other websites, nor social media outside Toymakr3d.com

1. 0_LS_ScrewA_BLACK
 2. 0_LS_ScrewB_BLACK
 3. 0_LS_ScrewC_BLACK
 4. 0_LS_ScrewD_BLACK
 5. 0_LS_ScrewE_BLACK
 6. 0_LS_ScrewF_RED
 7. 0_LS_ScrewG_BLACK
 8. 0_LS_ScrewH_SILVER
 9. 1a_LS_Head1_BLACK
 10. 1b_LS_Head2_GOLD
 11. 1c_LS_Head3_RED
 12. 1d_LS_Head4_SILVER
 13. 1e_LS_Head5_BLACK
 14. 1f_LS_Head6_PINEGREEN
 15. 1g_LS_Head7_GOLD
 16. 1h_LS_Head8_GOLD
 17. 1i_LS_Head9_GOLD
 18. 1j_LS_Head10_SILVER
 19. 1k_LS_Head11_BLACK
 20. 2a_LS_Chest1_BLACK
 21. 2b_LS_Chest2_RED
 22. 2c_LS_Chest3_GOLD
 23. 2d_LS_Chest4_GOLD
 24. 2e_LS_Chest5_GOLD
 25. 2f_LS_Chest6_PINEGREEN
 26. 2g_LS_Chest7_PINEGREEN
 27. 2h_LS_Chest8_BLACK
 28. 2i_LS_Chest9_BLACK
 29. 2j_LS_Chest10_SILVER
 30. 2k_LS_Chest11_RED
 31. 2l_LS_Chest12_SILVER
 32. 2m_LS_Chest13_RED
 33. 2n_LS_Chest14_BLACK
 34. 2o_LS_Chest15_BLACK
 35. 2p_LS_Chest16_BLACK
 36. 3a_LS_Abdomen1_BLACK
 37. 3b_LS_Abdomen2_GOLD
 38. 3c_LS_Abdomen3_RED
 39. 4a_LS_Waist1_BLACK
 40. 4b_LS_Waist2_BLACK

41. 4c_LS_Waist3_RED
 42. 4d_LS_Waist4_BLACK
 43. 4e_LS_Waist5_GOLD
 44. 4f_LS_Waist6_PINEGREEN
 45. 4g_LS_Waist7_PINEGREEN
 46. 4h_LS_Waist8_PINEGREEN
 47. 4i_LS_Waist9_RED
 48. 4j_LS_Waist10_GOLD
 49. 4k_LS_Waist11_BLACK
 50. 4l_LS_Waist12_RED
 51. 4m_LS_Waist13_RED
 52. 4n_LS_Waist14_BLACK
 53. 4o_LS_Waist15_RED
 54. 4p_LS_Waist16_BLACK
 55. 4q_LS_Waist17_RED
 56. 4r_LS_Waist18_RED
 57. 4s_LS_Waist19_RED
 58. 4t_LS_Waist20_GOLD
 59. 4u_LS_Waist21_BLACK
 60. 5a_LS_Hand1_BLACK
 61. 5b_LS_Hand2_BLACK
 62. 5c_LS_Hand3_RED
 63. 5d_LS_Hand4_BLACK
 64. 5e_LS_Hand5_RED
 65. 5f_LS_Hand6_BLACK
 66. 5g_LS_Hand7_SILVER
 67. 5h_LS_Hand8_GOLD
 68. 5i_LS_Hand9_GOLD
 69. 5j_LS_Hand10_GOLD
 70. 5k_LS_Hand11_GOLD
 71. 5l_LS_Hand12_RED
 72. 5m_LS_Hand13_BLACK
 73. 5n_LS_Hand14_BLACK
 74. 5o_LS_Hand15_RED
 75. 5p_LS_Hand16_RED
 76. 5q_LS_Hand17_GOLD
 77. 5r_LS_Hand18_GOLD
 78. 5s_LS_Hand19_BLACK
 79. 5tA_LS_Hand20_GOLD
 80. 5tB_LS_Hand20_GOLD

81. 5tC_LS_Hand20_GOLD
 82. 5tD_LS_Hand20_GOLD
 83. 5uA_LS_Hand21_BLACK
 84. 5uB_LS_Hand21_BLACK
 85. 5uC_LS_Hand21_BLACK
 86. 5uD_LS_Hand21_BLACK
 87. 5uE_LS_Hand21_BLACK
 88. 5uF_LS_Hand21_BLACK
 89. 5uG_LS_Hand21_BLACK
 90. 5uH_LS_Hand21_BLACK
 91. 6a_LS_Thigh1_BLACK
 92. 6b_LS_Thigh2_RED
 93. 6c_LS_Thigh3_PINEGREEN
 94. 6d_LS_Thigh4_SILVER
 95. 6e_LS_Thigh5_RED
 96. 7aL_LS_Shin1_BLACK
 97. 7aR_LS_Shin1_BLACK
 98. 7b_LS_Shin2_BLACK
 99. 7c_LS_Shin3_BLACK
 100. 7d_LS_Shin4_SILVER
 101. 7e_LS_Shin5_BLACK
 102. 7f_LS_Shin6_SILVER
 103. 7g_LS_Shin7_BLACK
 104. 7hL_LS_Shin8_GOLD
 105. 7hR_LS_Shin8_BLUE
 106. 7iL_LS_Shin9_RED
 107. 7iR_LS_Shin9_GOLD
 108. 7jL_LS_Shin10_GOLD
 109. 7jR_LS_Shin10_BLUE
 110. 7kL_LS_Shin11_RED
 111. 7kR_LS_Shin11_GOLD
 112. 7lL_LS_Shin12_GOLD
 113. 7lR_LS_Shin12_BLUE
 114. 7mL_LS_Shin13_SILVER
 115. 7mR_LS_Shin13_GOLD
 116. 7nL_LS_Shin14_GOLD
 117. 7nR_LS_Shin14_BLUE
 118. 7oL_LS_Shin15_SILVER
 119. 7oR_LS_Shin15_GOLD
 120. 7pL_LS_Shin16_SILVER

121. 7pR_LS_Shin16_BLUE
 122. 7qL_LS_Shin17_GOLD
 123. 7qR_LS_Shin17_BLUE
 124. 7rL_LS_Shin18_RED
 125. 7rR_LS_Shin18_RED
 126. 7sL_LS_Shin19_GOLD
 127. 7sR_LS_Shin19_BLUE
 128. 7tL_LS_Shin20_SILVER
 129. 7tR_LS_Shin20_GOLD
 130. 7uL_LS_Shin21_GOLD
 131. 8aL_LS_Foot1_BLACK
 132. 8aR_LS_Foot1_BLACK
 133. 8bL_LS_Foot2_SILVER
 134. 8bR_LS_Foot2_GOLD
 135. 8cL_LS_Foot3_GOLD
 136. 8cR_LS_Foot3_BLUE
 137. 8dL_LS_Foot4_SILVER
 138. 8dR_LS_Foot4_GOLD
 139. 8e_LS_Foot5_SILVER
 140. 8fL_LS_Foot6_BLACK
 141. 8fR_LS_Foot6_BLACK
 142. 8gL_LS_Foot7_GOLD
 143. 8gR_LS_Foot7_BLUE
 144. 8hL_LS_Foot8_SILVER
 145. 8hR_LS_Foot8_GOLD
 146. 8iL_LS_Foot9_GOLD
 147. 8iR_LS_Foot9_BLUE
 148. 8j_LS_Foot10_RED
 149. 8k_LS_Foot11_RED
 150. 9a_Katana1_GOLD
 151. 9b_Katana2_GOLD
 152. 9c_Katana3_SILVER
 153. 9d_Katana4_PINEGREEN
 154. 9e_Katana5_BLACK
 155. 9f_Katana6_GOLD
 156. 9g_Katana7_GOLD
 157. 9h_Katana8_BLACK
 158. 9i_Katana9_BLACK
 159. 9j_Katana10_BLACK
 160. 9k_Katana11_BLACK

161. 9l_Katana12_BLACK
 162. 10a_Katana1_BLACK
 163. 10b_Katana2_GOLD
 164. 10c_Katana3_SILVER
 165. 10d_Katana4_BLACK
 166. 10e_Katana5_GOLD
 167. 10f_Katana6_GOLD
 168. 11a_LS_Spear1_GOLD
 169. 11b_LS_Spear2_GOLD
 170. 11c_LS_Spear3_BLACK
 171. 11d_LS_Spear4_GOLD
 172. 11e_LS_Spear5_GOLD
 173. 11f_LS_Spear6_BLACK
 174. 11g_LS_Spear7_GOLD
 175. 11h_LS_Spear8_BLACK
 176. 12a_LS_BlastEffectLarge_ORANGE
 177. 12b_LS_BlastEffectSmall_ORANGE
 178. ScrewDriver

For Resin Print Options:

179. Z(Resin)0_LS_ScrewA_BLACK
 180. Z(Resin)0_LS_ScrewB_BLACK
 181. Z(Resin)0_LS_ScrewC_BLACK
 182. Z(Resin)0_LS_ScrewD_BLACK
 183. Z(Resin)0_LS_ScrewE_BLACK
 184. Z(Resin)0_LS_ScrewF_RED
 185. Z(Resin)0_LS_ScrewG_BLACK
 186. Z(Resin)0_LS_ScrewH_SILVER
 187. Z(Resin)9c_Katana3_SILVER
 188. Z(Resin)10c_Katana3_SILVER
 189. Z(Resin)11a_LS_Spear1_GOLD
 190. Z(Resin)11c_LS_Spear3_BLACK
 191. Z(Resin)11f_LS_Spear6_BLACK
 192. Z(Resin)12a_LS_BlastEffectLarge_ORANGE
 193. Z(Resin)12b_LS_BlastEffectSmall_ORANGE



Receive high tension / pressure!
 Print these parts at minimum 75% Infill

2n_LS_Chest14_BLACK



4c_LS_Waist3_RED



2p_LS_Chest16_BLACK

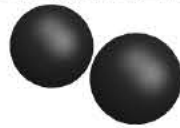

4u_LS_Waist21_BLACK

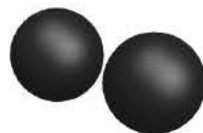

4f_LS_Waist6_PINEGREEN



7g_LS_Shin7_BLACK



4s_LS_Waist19_RED



Screw driver



Screws:



1

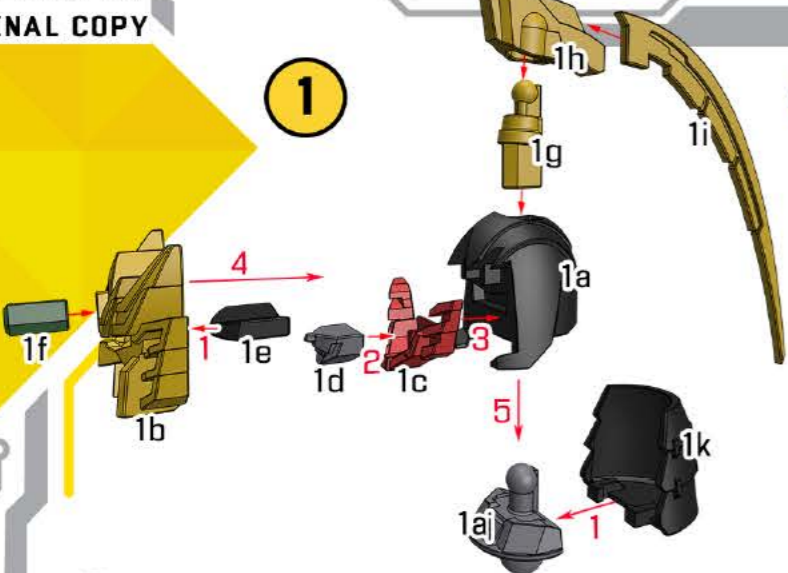

2



DO NOT MISS STEP NO 2!

3

DO NOT DO STEP NO 3 BEFORE STEP NO 2!

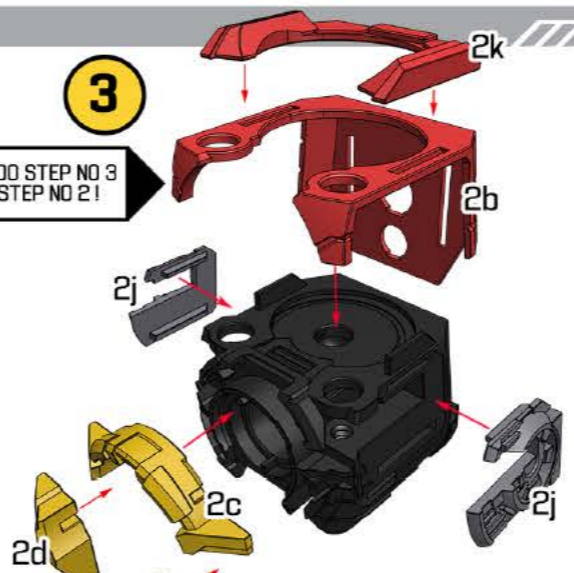

4

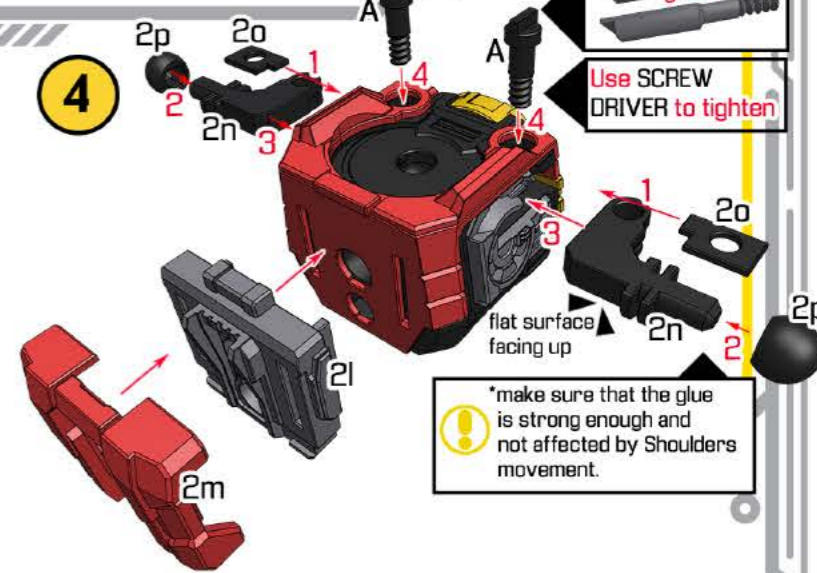

Use SCREW DRIVER to tighten

*make sure that the glue is strong enough and not affected by Shoulders movement.

5

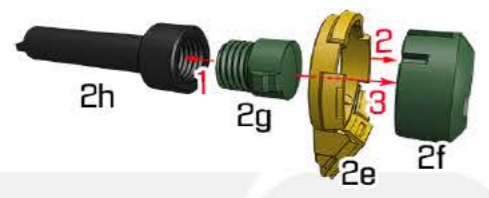

7



8

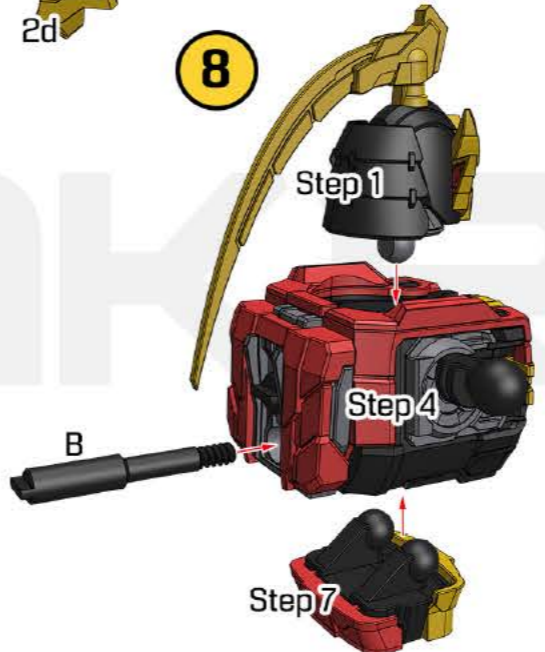

9

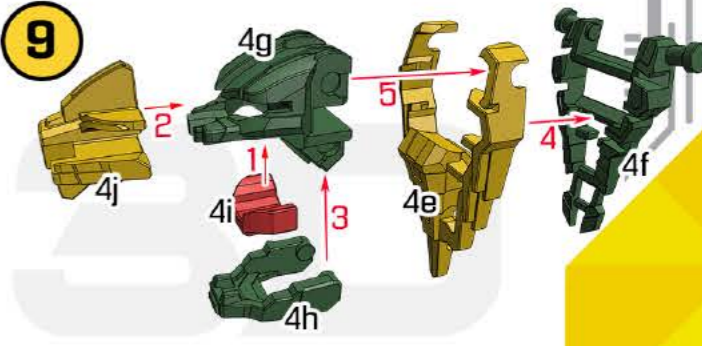

6

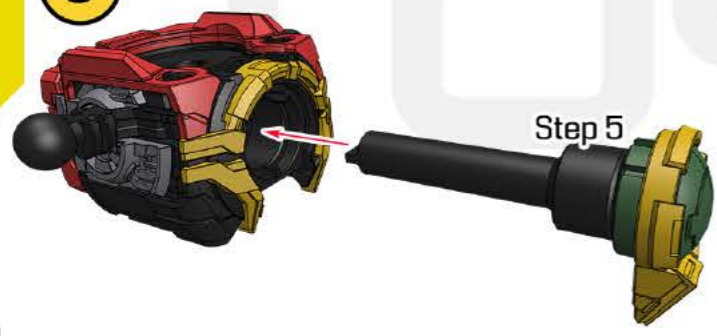

11

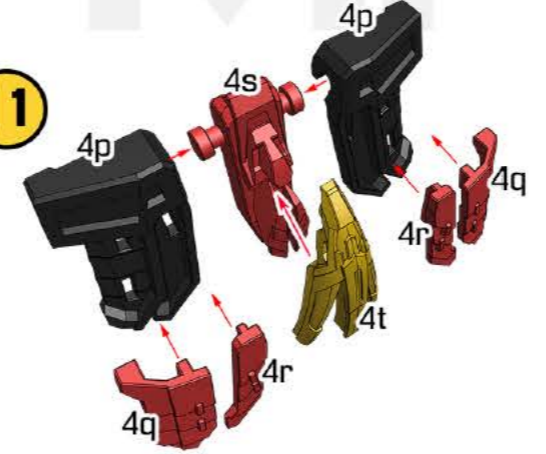

13

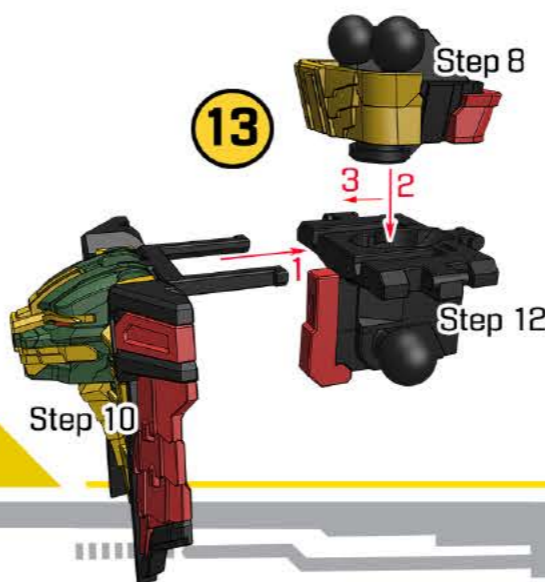

14

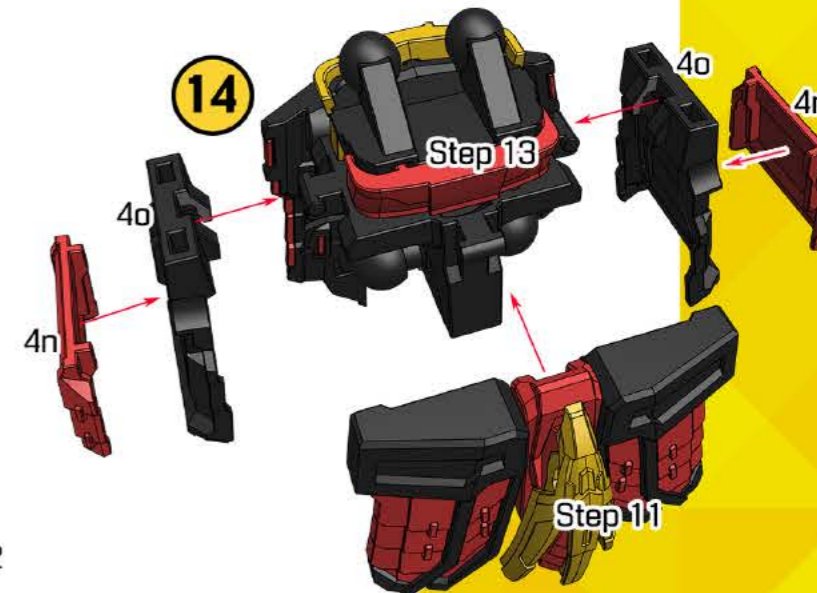

10

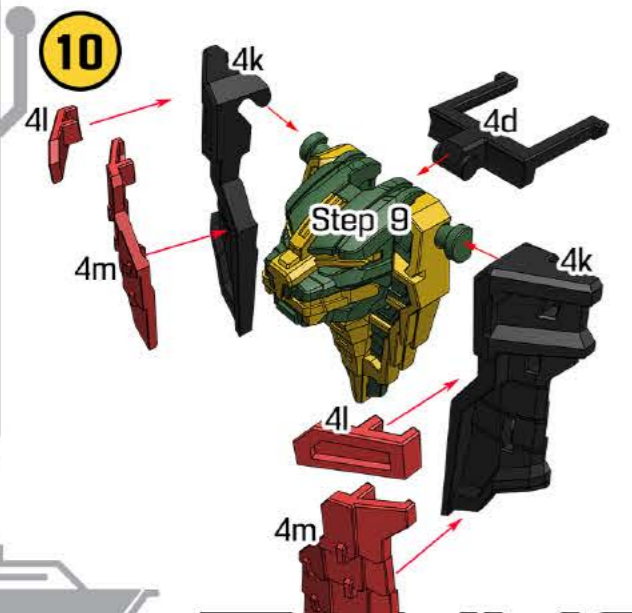

12



*make sure that the glue is strong enough and not affected by Hips movement.



15 DO THIS STEP TWICE FOR R & L SIDE

16 DO THIS STEP TWICE FOR R & L SIDE

17 THESE STEPS ARE FOR LEFT HAND WITH "L" MARK. MIRROR THESE STEPS FOR RIGHT HAND

18

19 Step 16

20 Step 17

21 THIS STEP IS FOR LEFT THIGH WITH "L" MARK. MIRROR THIS STEPS FOR RIGHT THIGH

22 DO THIS STEP TWICE FOR R & L SIDE

MIRROR THE HAND FILES FOR R/L SIDE

23 Right Shin

24 Right Shin

25 Right Shin

27

Right Leg

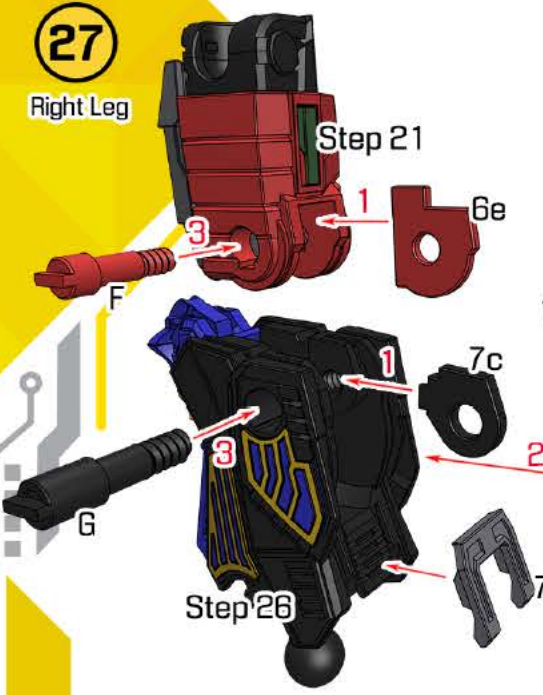

28

Right Foot

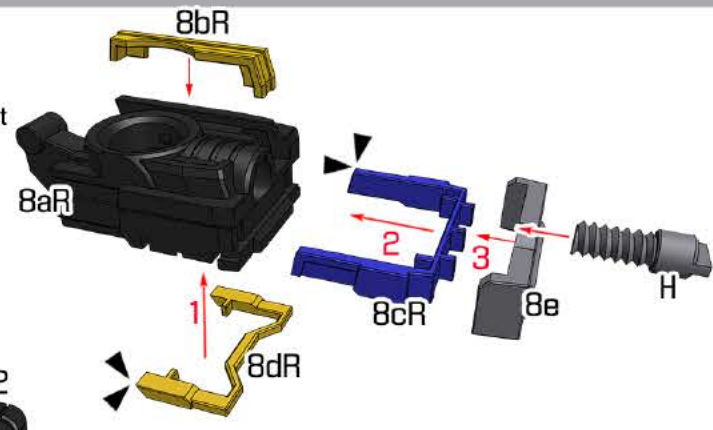

29

Right Foot

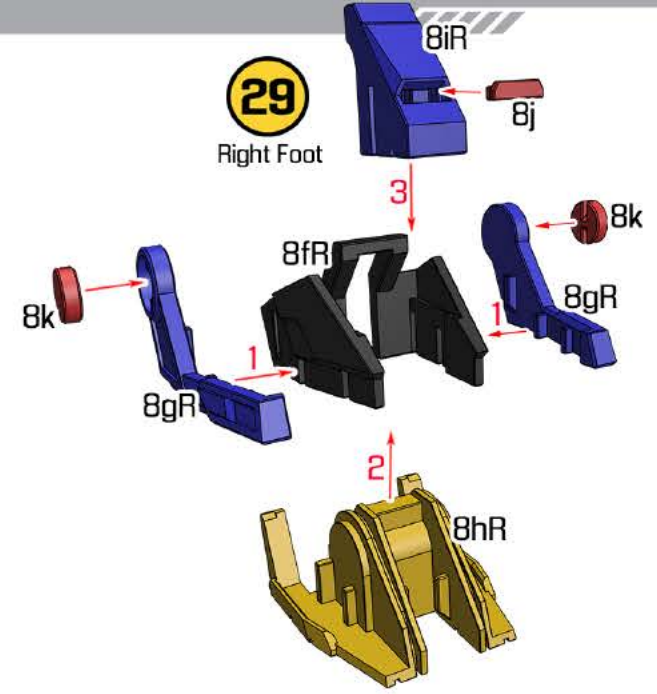

30

Right Foot

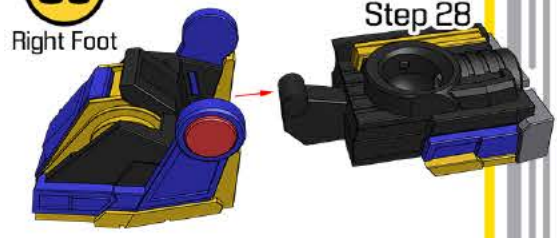

32

Left Shin

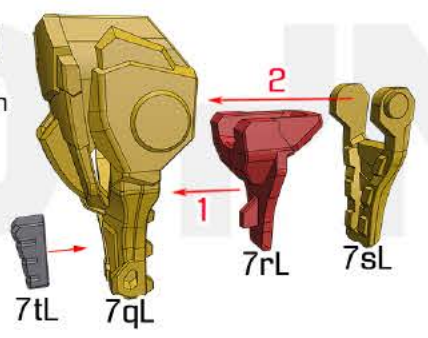

34

Left Shin

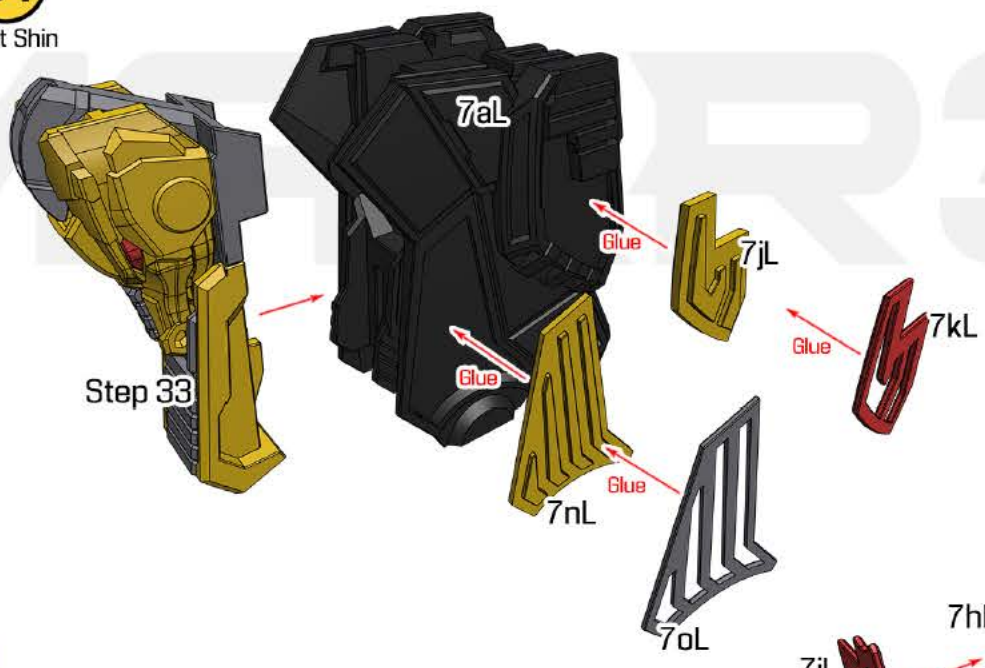

33

Left Shin

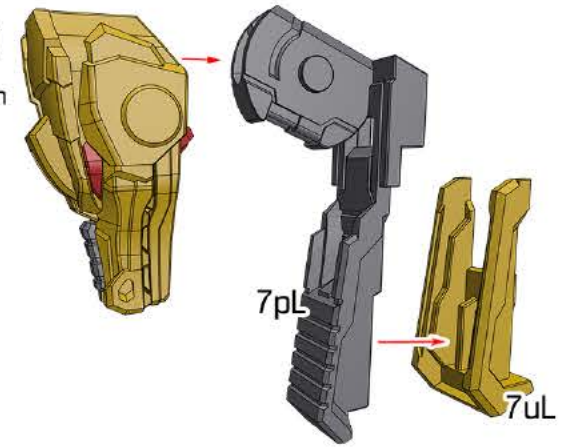

35

Left Shin

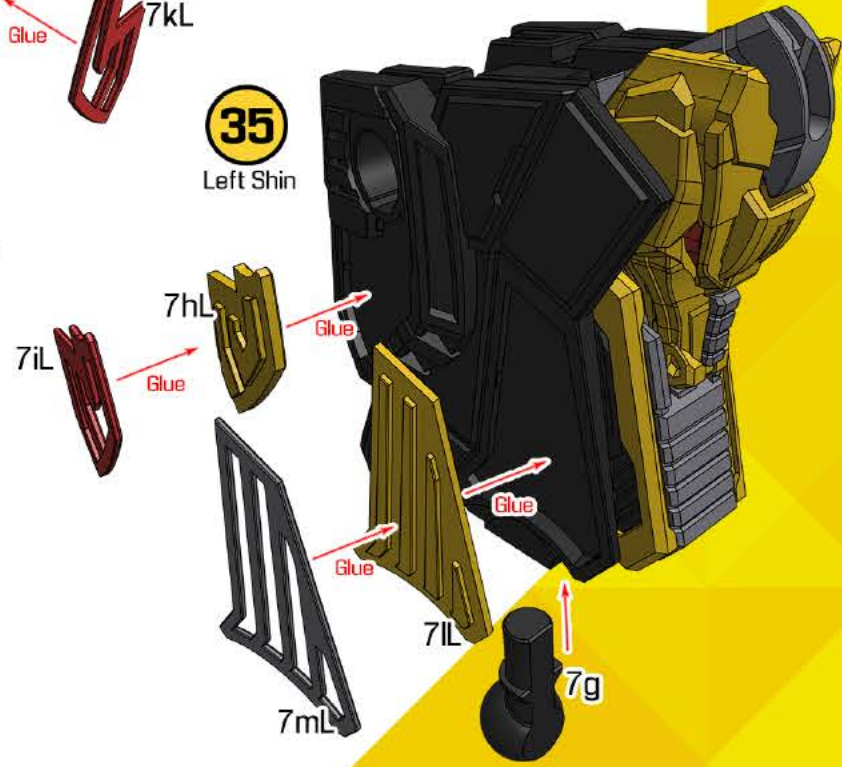

31

Right Foot



36

Left Leg

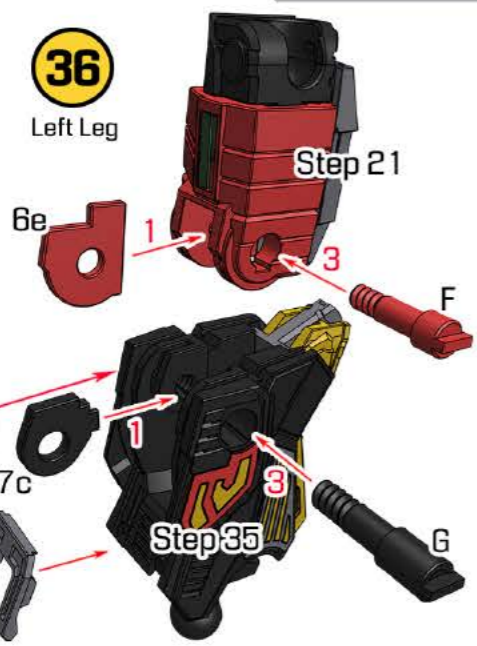

37

Left Foot

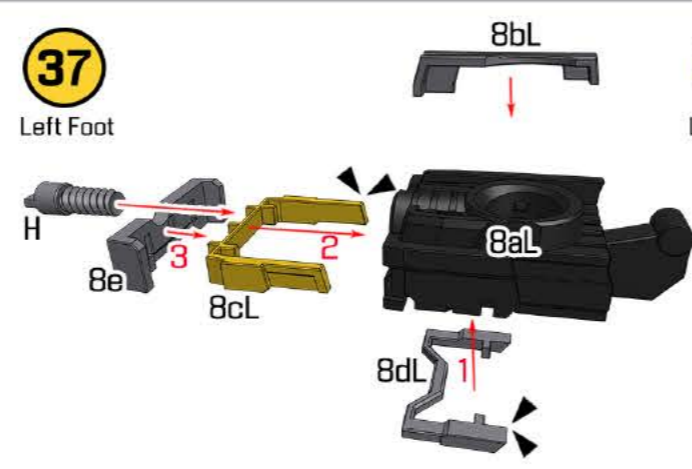

38

Left Foot

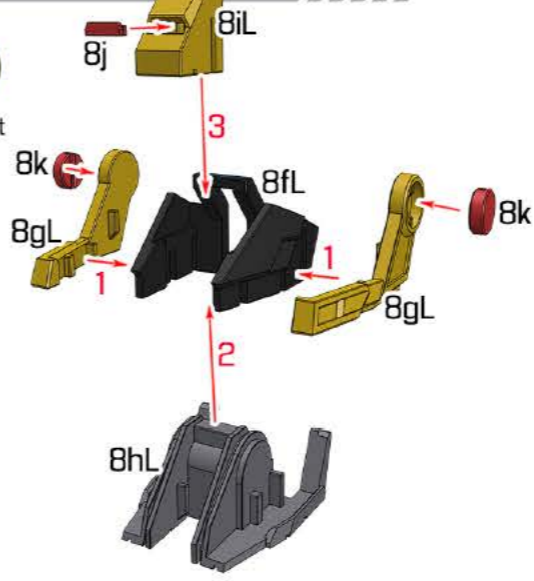

39

Left Foot

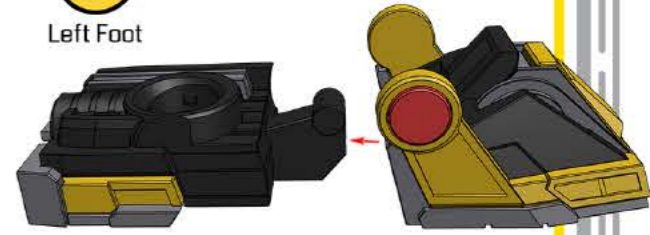

40



41



42

Sword 1

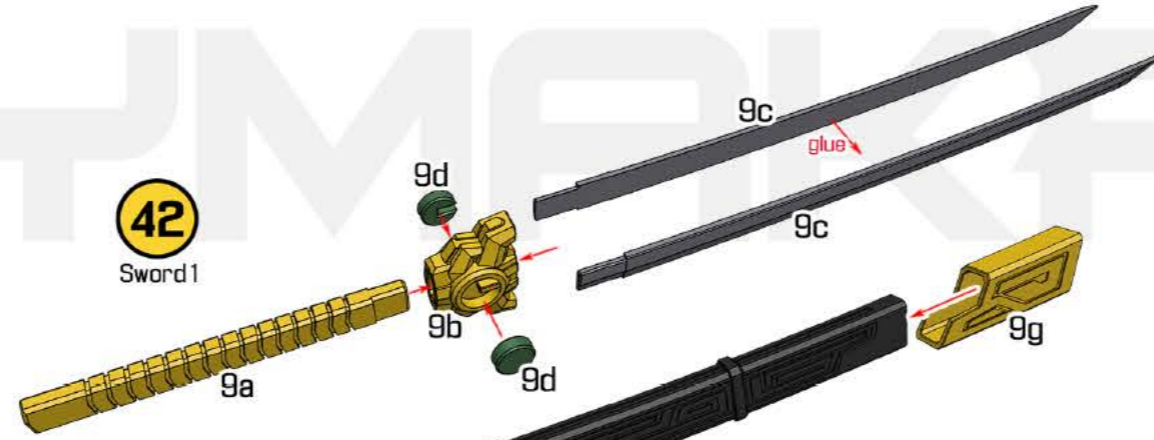

43

Sword 1



44

Sword 2



45

Sword 2



46

Sword Holder

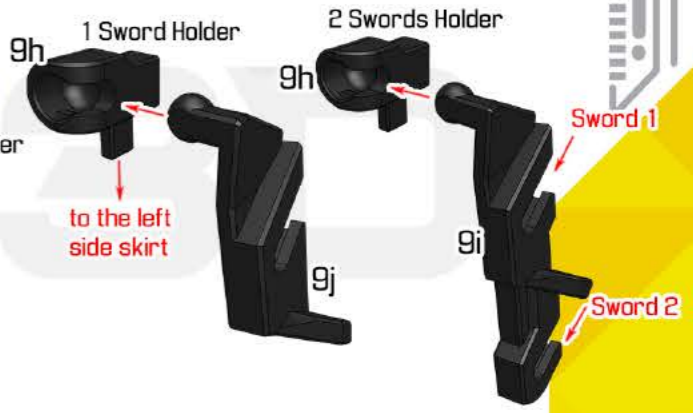

47

Sword Stand

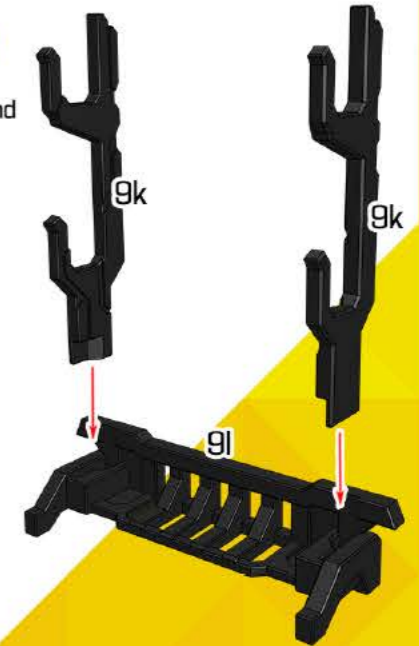

48

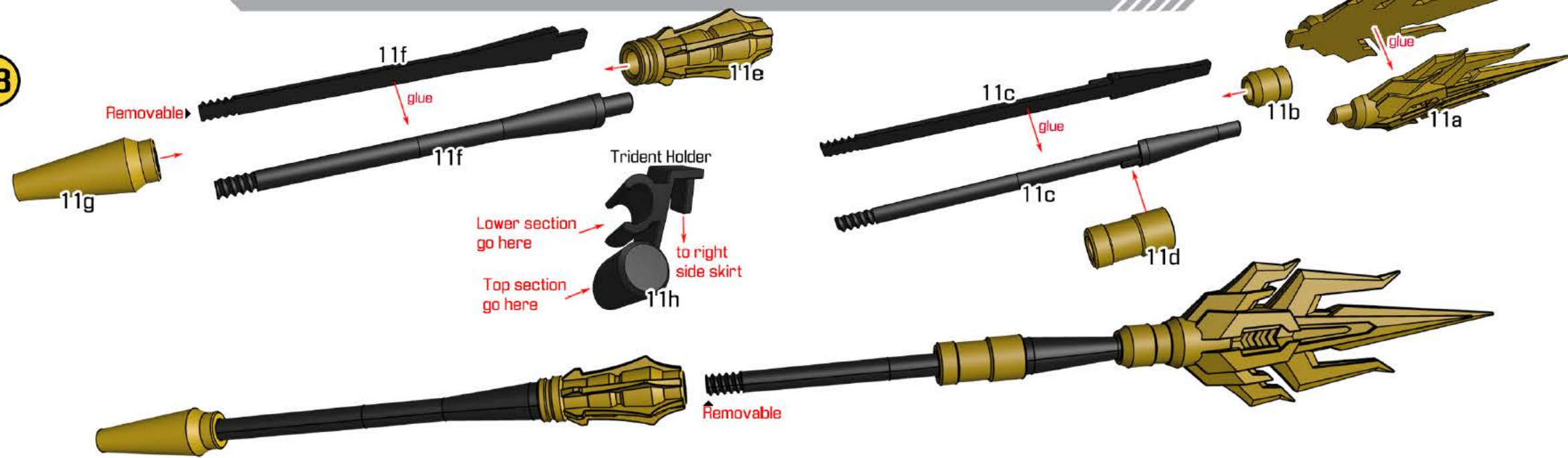

49

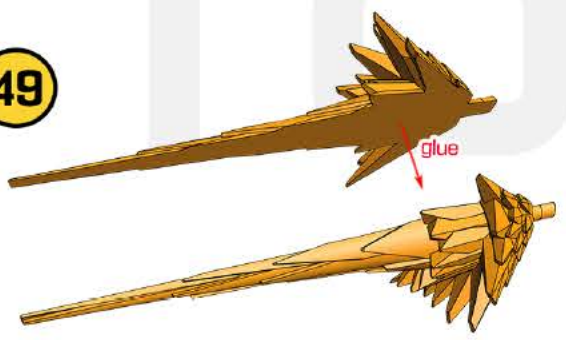

50

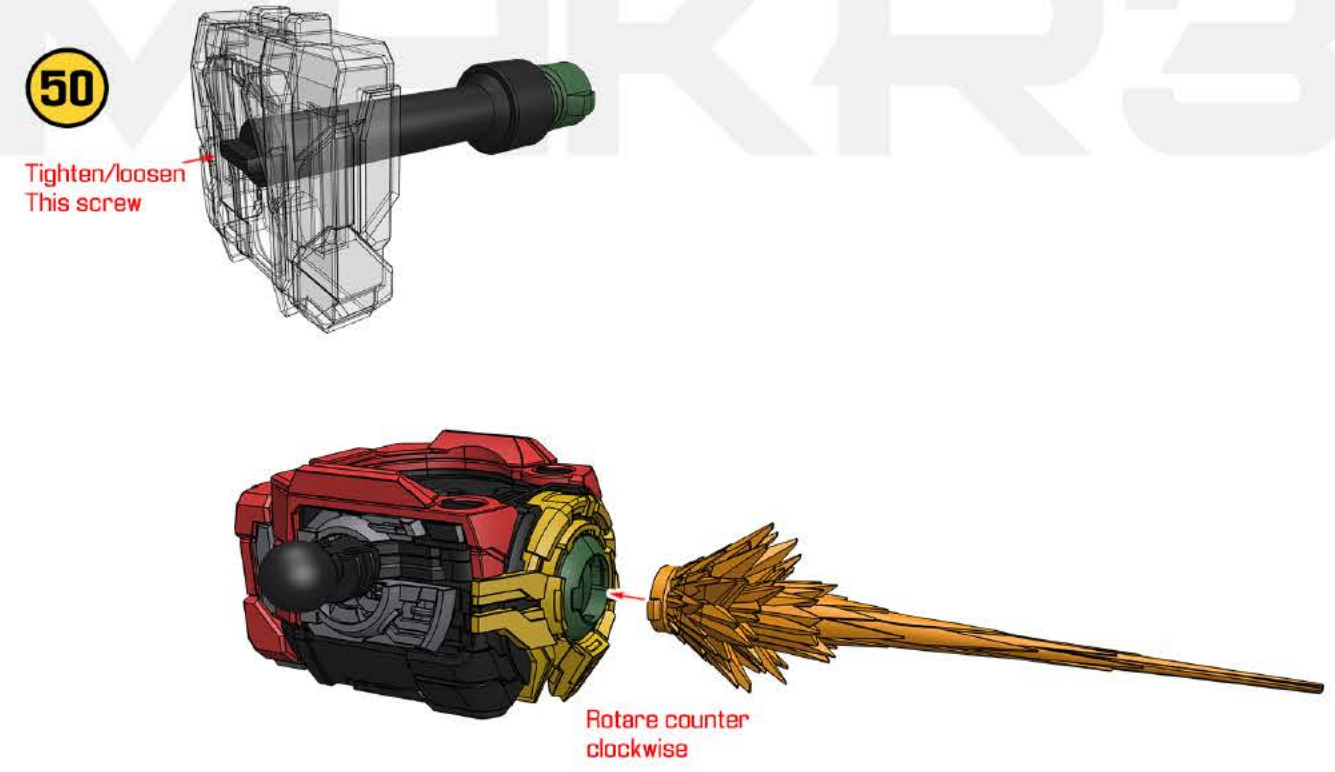

TOYMAKER3D