

SUPERION INSTRUCTION 1

Design by Reza Aulia
Source: Toymakr3d.com

License: CC BY-NC-ND
- Attribution - Non Commercial - No Derivatives

1



2

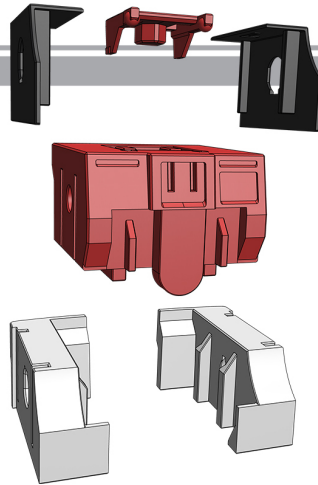

3

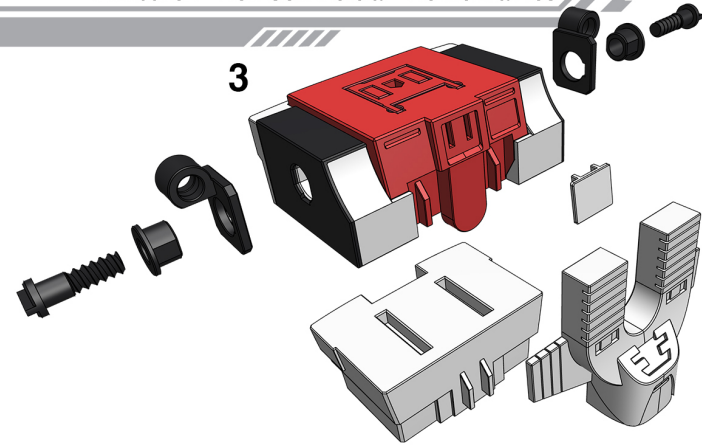

4

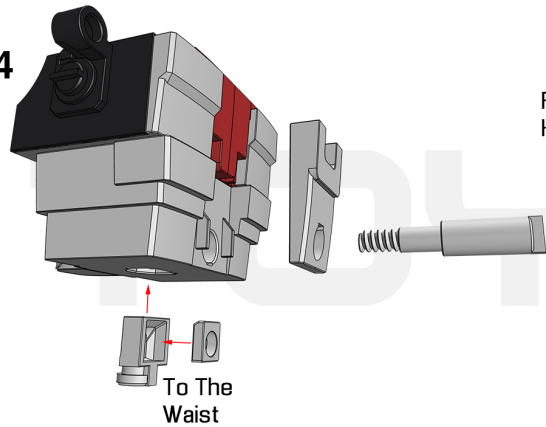

5
Right
Hand

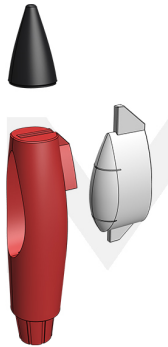

6

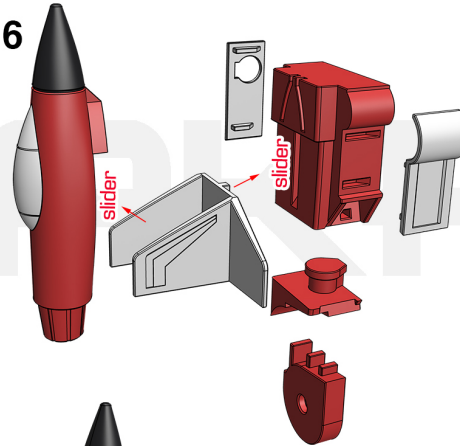

7



8

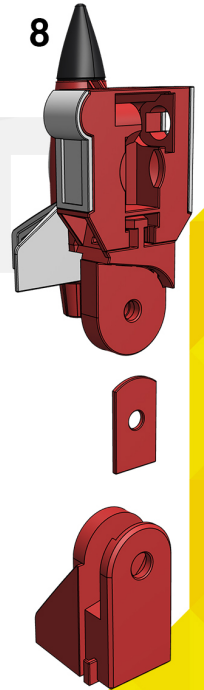

9

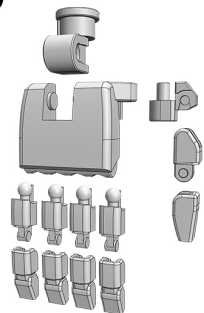

10

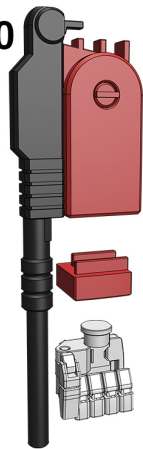

11

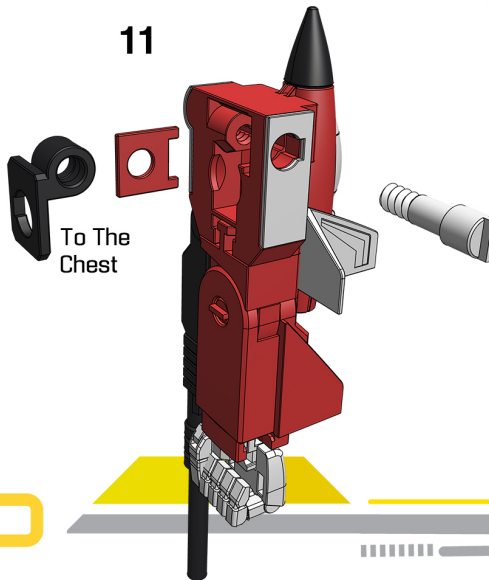

SETTINGS:
Support : NO
Nozzle: 0.4mm
Layer: 0.2mm (0.1mm for the Face)
Filament: PLA+
Temperature: 205°C
Speed: 40 mm/s
Skin/top/bottom: 0.8 mm
Infill: 20-25%

SUPERION INSTRUCTION 2

Design by Reza Aulia
Source: Toymakr3d.com

License: CC BY-NC-ND
- Attribution - Non Commercial - No Derivatives

12
Left Hand
with "L" mark

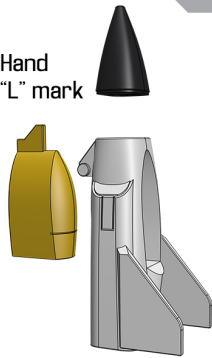

13

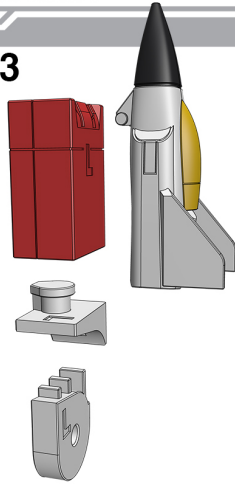

14

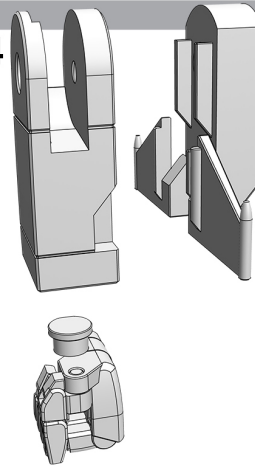

15

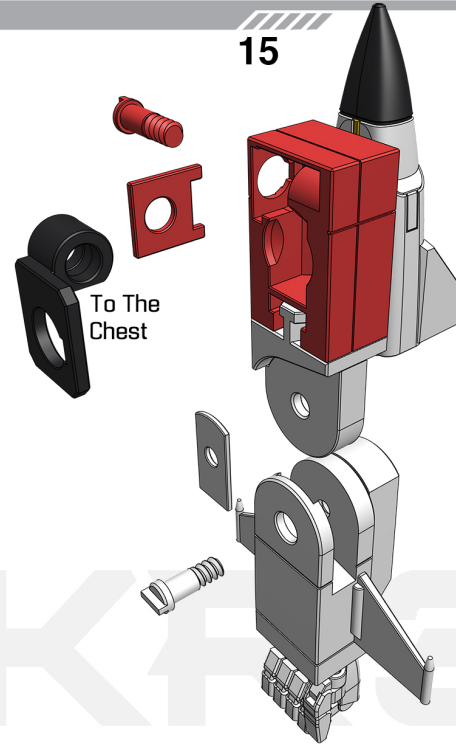

16
Right
Leg

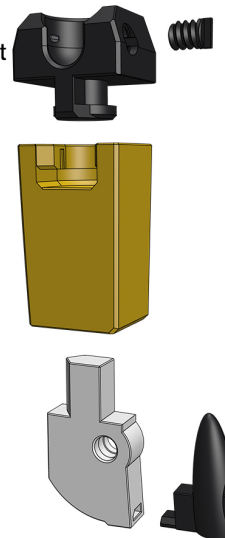

18

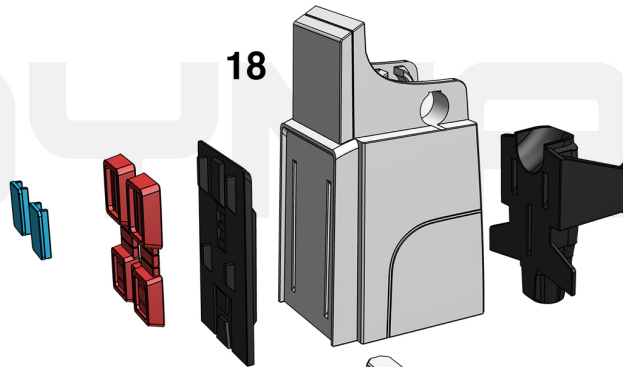

To The
Waist

20

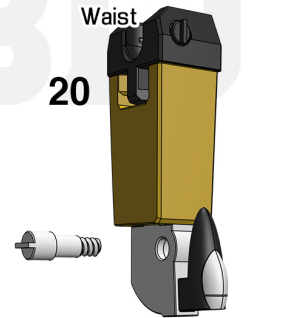

17

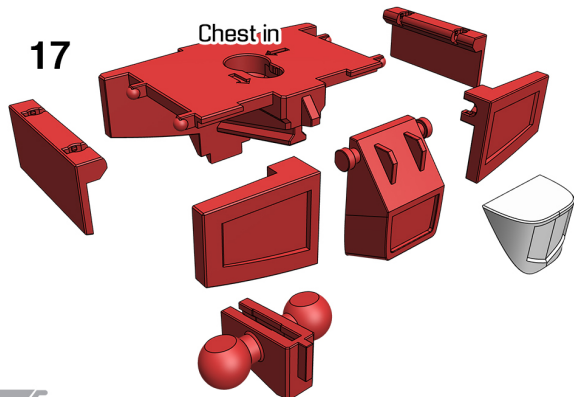

19

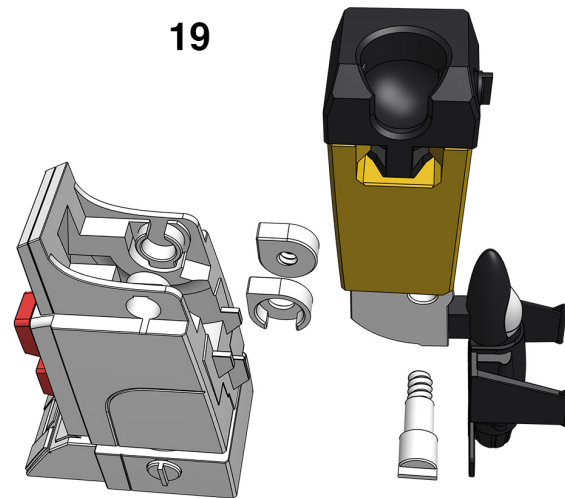

SUPERION INSTRUCTION 3

Design by Reza Aulia
Source: Toymakr3d.com

License: CC BY-NC-ND
- Attribution - Non Commercial - No Derivatives

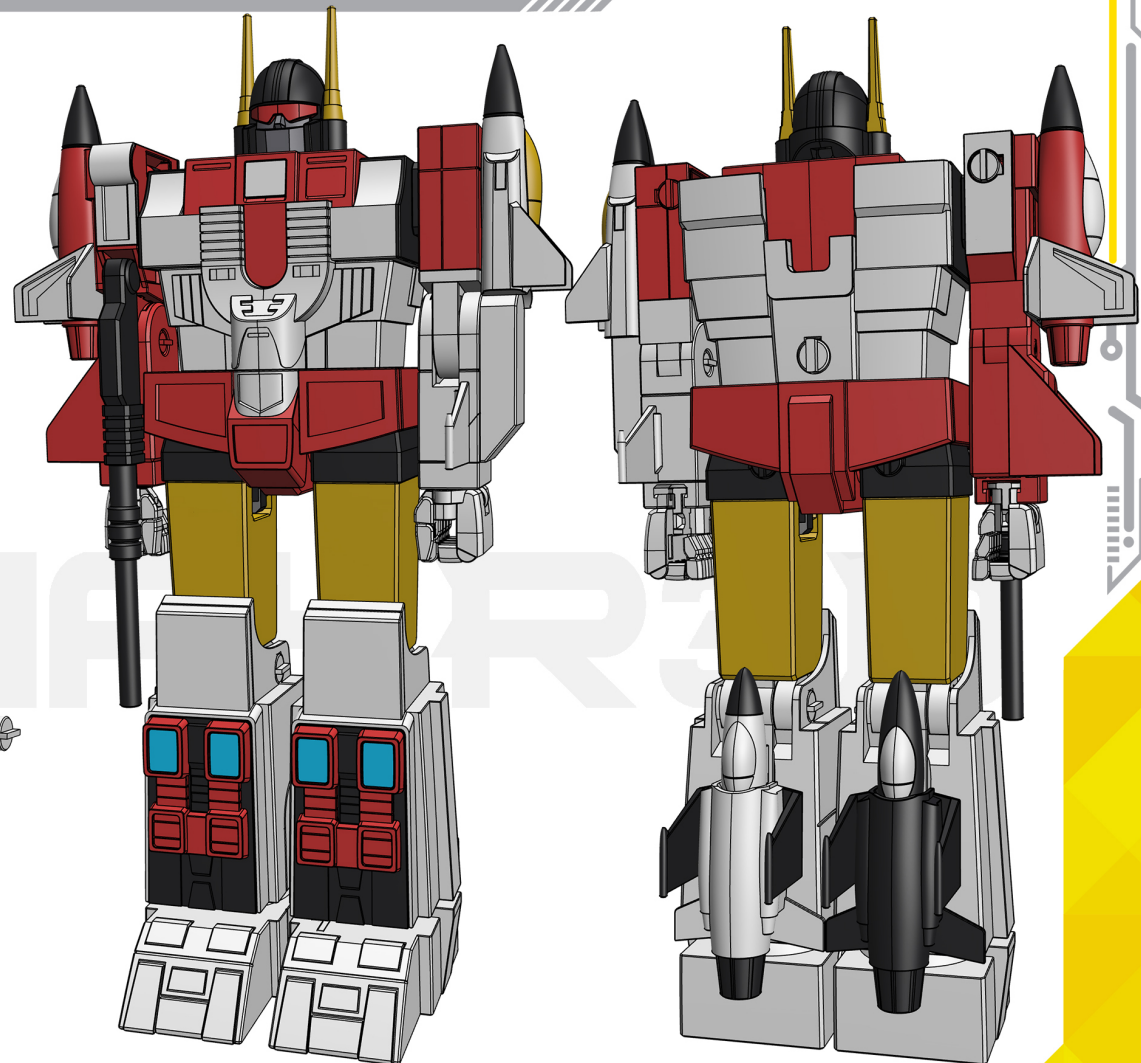
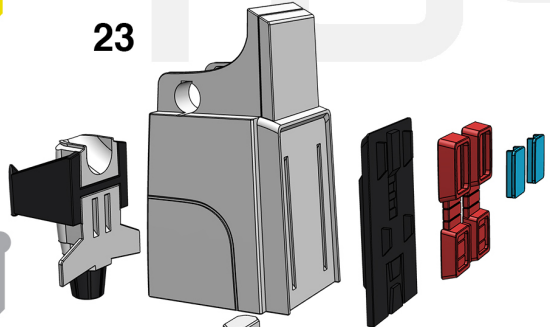
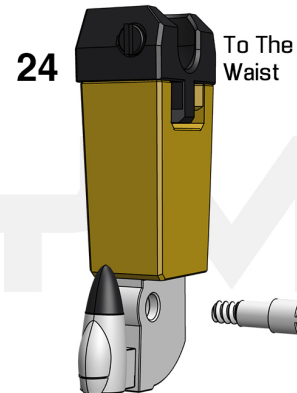
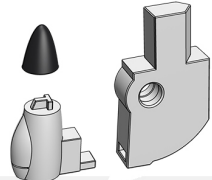
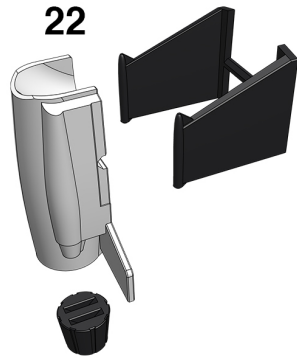
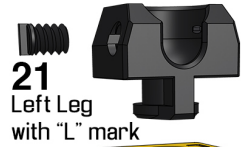

- **WARNING!**: Contains small parts and requires high precision. Your printer may need to be properly calibrated for best results. (Tolerances: Peg 0.15mm, Balljoint 0mm, Slide 0.3mm, Screw 0.4mm)
- **USE CLEAR NAIL POLISH TO TIGHTEN THE JOINTS:** Use it on both female and male ball joint or on friction joint surfaces. Wait until it dry before put them together
- **DISCLAIMER:** This model is for fan art purposes only. The creator is in no way associated with the original Transformers character license owner.