



ORIGINAL COPY

TM3D-08

PROJECT EV-01

INSTRUCTION 1

CC BY-NC-ND - Attribution - Non Commercial - No Derivatives

xiaoping zhu | UHEMFTVE | TM3D-UHEMFTVE-20220613210805



Contains small parts and requires high precision. Your printer may need to be properly calibrated for best results. (Tolerances: Peg 0.15mm, Balljoint 0mm, Slide 0.3mm, Screw 0.4mm)



Settings:

Minimum printer size: 200mmX200mmX200mm
Support : NO
Nozzle: 0.4mm
Layer: 0.15mm (0.1 for the head)
Filamen: PLA
Temperature: 200°C
Speed: 40/s
Skin/top/bottom: 0.8mm
Infill: 20%-25% (100% for crew)

Height

Total : 350 mm
Light Blue : 1 Part, 2 grams
White : 54 Parts, 267 grams
Grey : 178 Parts, 185 grams
Red : 18 Parts, 77 grams
Green : 9 Parts, 19 grams
Yellow : 9 Parts, 10 grams
Purple : 26 Parts, 124 grams
Black : 38 Parts, 91 grams
Blue : 9 Parts, 47 grams

Biggest Part:

Highest : 9e_Ev_Rocket5_WHITE [113 mm H]
Longest : 11b_Ev_Katana2_RED [230 mm L, Positioned diagonally]
Volume : 2a_Ev_Chest1_BLUE [68mm L X 43mm W X 50mm H]

Tools: Cutter, Sand Paper, Super Glue, Nail Polish



Tips & Tricks:

Print result isn't smooth enough and parts aren't fit properly:
- Calibrate your printer properly
- Make sure you print it in right temperature
- If you print it too fast, it may cause ghosting on the surface of the object
- Decrease the layer height (0.15mm for small figure and 1 mm for the head/face)

Object won't stick to the print bed:

- Setup your bed leveling properly
- Use brim for small objects which have small contact to the bed
- Increase first layer extrusion to 125%-150%
- If you are using Buildtak, sand the surface using sand paper
- Set the printing speed of the first layer to 20 m/s

How to fix loose ball joint?

- Material Shrinkage: PLA 0.2%, ABS 0.8%
- Use clear nail polish. Use it on both female and male ball joint section or on friction joint surfaces. Wait until it dry before put them back in place
- If the ball joint is loose right after printing, it may cause by under extrusion. Increase filament flow rate by 110% - 125%

Finishing touch

- Use cutter or sand paper for peg adjustment
- Use super glue to assemble the part
- Spray the finishing object using clear coat to protect the object from the weather for long term use.

SCAN ME



Apple Augmented Reality*

*IPADOS or iOS 12.0+



BY BUYING THIS PRODUCT YOU AGREE TO THESE TERMS:
LICENSE: Attribution-NonCommercial-NoDerivatives 4.0
International (CC BY-NC-ND 4.0)

1. **ATTRIBUTION:** You must give appropriate credit, provide a link to the license, and indicate if changes were made. You may do so in any reasonable manner, but not in any way that suggests the licensor endorses you or your use.
 2. **NONCOMMERCIAL:** You may not use the material for commercial purposes.
 3. **NO DERIVATIVES:** If you remix, transform, or build upon the material, you may not distribute the modified material.
- ADDITIONAL RESTRICTION** — You are not allowed to share these FILES on other websites, nor social media outside Toymakr3d.com

TOYMAKR3D

TOY MAKER FOR 3D PRINTING

WWW.TOYMAKR3D.COM



ORIGINAL COPY

TM3D-08

PROJECT EV-01

INSTRUCTION 2

CC BY-NC-ND - Attribution - Non Commercial - No Derivatives

xiaoping zhu | UHEMFTVE | TM3D-UHEMFTVE-20220613210805

FILES:

- 1. 0_Ev_ScrewA_BLUE
- 2. 0_Ev_ScrewB_BLACK
- 3. 0_Ev_ScrewC_BLACK
- 4. 0_Ev_ScrewD_PURPLE
- 5. 0_Ev_ScrewE_GREY
- 6. 0_Ev_ScrewF_BLACK
- 7. 0_Ev_ScrewG_WHITE
- 8. 0_Ev_ScrewH_WHITE
- 9. 0_Ev_ScrewI_WHITE
- 10. 0_Ev_ScrewJ_GREY
- 11. 1a_Ev_Head1_WHITE
- 12. 1b_Ev_Head2_RED
- 13. 1c_Ev_Head3_BLACK
- 14. 1d_Ev_Head4_WHITE
- 15. 1e_Ev_Head5_GREY
- 16. 1f_Ev_Head6_GREY
- 17. 1g_Ev_Head7_WHITE
- 18. 1h_Ev_Head8_RED
- 19. 1i_Ev_Head9_RED
- 20. 2a_Ev_Chest1_BLUE
- 21. 2b_Ev_Chest2_BLUE
- 22. 2c_Ev_Chest3_PURPLE
- 23. 2d_Ev_Chest4_YELLOW
- 24. 2e_Ev_Chest5_BLACK
- 25. 2f_Ev_Chest6_RED
- 26. 2g_Ev_Chest7_WHITE
- 27. 2h_Ev_Chest8_WHITE
- 28. 2i_Ev_Chest9_GREY
- 29. 2j_Ev_Chest10_GREY
- 30. 2k_Ev_Chest11_YELLOW
- 31. 2l_Ev_Chest12_LIGHTBLUE
- 32. 2m_Ev_Chest13_BLACK
- 33. 2n_Ev_Chest14_BLACK
- 34. 2o_Ev_Chest15_BLACK
- 35. 2p_Ev_Chest16_BLUE
- 36. 2q_Ev_Chest17_GREY
- 37. 2r_Ev_Chest18_BLACK
- 38. 2s_Ev_Chest19_WHITE
- 39. 2t_Ev_Chest20_BLACK
- 40. 2u_Ev_Chest21_BLACK
- 41. 3a_Ev_Abdomen1_BLACK
- 42. 3b_Ev_Abdomen2_PURPLE
- 43. 3c_Ev_Abdomen3_BLACK
- 44. 3d_Ev_Abdomen4_BLACK
- 45. 3e_Ev_Abdomen5_BLACK
- 46. 3f_Ev_Abdomen6_GREEN
- 47. 3g_Ev_Abdomen7_BLACK
- 48. 4a_Ev_Waist1_PURPLE
- 49. 4b_Ev_Waist2_BLACK
- 50. 4c_Ev_Waist3_PURPLE
- 51. 4d_Ev_Waist4_WHITE
- 52. 4e_Ev_Waist5_GREY
- 53. 4f_Ev_Waist6_WHITE
- 54. 4g_Ev_Waist7_RED
- 55. 4h_Ev_Waist8_WHITE
- 56. 4i_Ev_Waist9_GREY
- 57. 5a_Ev_Hand1_WHITE
- 58. 5b_Ev_Hand2_BLACK
- 59. 5c_Ev_Hand3_PURPLE
- 60. 5d_Ev_Hand4_BLACK
- 61. 5e_Ev_Hand5_GREEN
- 62. 5f_Ev_Hand6_PURPLE
- 63. 5g_Ev_Hand7_GREEN
- 64. 5h_Ev_Hand8_RED
- 65. 5i_Ev_Hand9_GREY
- 66. 5j_Ev_Hand10_WHITE
- 67. 5k_Ev_Hand11_PURPLE
- 68. 5l_Ev_Hand12_GREEN
- 69. 5m_Ev_Hand13_GREY
- 70. 5n_Ev_Hand14_GREY
- 71. 5o_Ev_Hand15_WHITE
- 72. 5p_Ev_Hand16_PURPLE
- 73. 5q_Ev_Hand17_WHITE
- 74. 5r_Ev_Hand18FistL_GREY
- 75. 5r_Ev_Hand18FistR_GREY
- 76. 5r_Ev_Hand18FistIndexFinger
- 77. 6a_Ev_Leg1_BLACK
- 78. 6b_Ev_Leg2_PURPLE
- 79. 6c_Ev_Leg3_PURPLE
- 80. 6d_Ev_Leg4_WHITE
- 81. 6e_Ev_Leg5_WHITE
- 82. 6f_Ev_Leg6_GREY
- 83. 6g_Ev_Leg7_WHITE
- 84. 6h_Ev_Leg8_GREY
- 85. 6i_Ev_Leg9_GREY
- 86. 6j_Ev_Leg10_PURPLE
- 87. 6k_Ev_Leg11_PURPLE
- 88. 6l_Ev_Leg12L_WHITE
- 89. 6l_Ev_Leg12R_WHITE
- 90. 6m_Ev_Leg13_GREEN
- 91. 6n_Ev_Leg14_BLACK
- 92. 6o_Ev_Leg15_YELLOW
- 93. 6p_Ev_Leg16_GREY
- 94. 6q_Ev_Leg17_GREY
- 95. 6r_Ev_Leg18_GREY
- 96. 6s_Ev_Leg19_WHITE
- 97. 6t_Ev_Leg20_WHITE
- 98. 6u_Ev_Leg21_RED
- 99. 6v_Ev_Leg22_RED
- 100. 6w_Ev_Leg23_GREY
- 101. 7a_Ev_Shield1_GREY
- 102. 7b_Ev_Shield2_GREY
- 103. 7c_Ev_Shield3_GREY
- 104. 7d_Ev_Shield4_GREY
- 105. 7e_Ev_Shield5_WHITE
- 106. 7f_Ev_Shield6_WHITE
- 107. 7g_Ev_Shield7_WHITE
- 108. 7h_Ev_Shield8_RED
- 109. 7i_Ev_Shield9_RED
- 110. 7j_Ev_Shield10_YELLOW
- 111. 7k_Ev_Shield11_GREY
- 112. 7l_Ev_Shield12_YELLOW
- 113. 7m_Ev_Shield13_GREY
- 114. 8a_Ev_Gun1_GREY
- 115. 8b_Ev_Gun2_GREY
- 116. 8c_Ev_Gun3_GREY
- 117. 8d_Ev_Gun4_GREY
- 118. 9a_Ev_Rocket1_GREY
- 119. 9b_Ev_Rocket2_WHITE
- 120. 9c_Ev_Rocket3_GREY
- 121. 9d_Ev_Rocket4_GREY
- 122. 9e_Ev_Rocket5_WHITE
- 123. 9f_Ev_Rocket6_GREY
- 124. 10a_Ev_Sword1_WHITE
- 125. 10b_Ev_Sword2_RED
- 126. 11a_Ev_Katana1_WHITE
- 127. 11b_Ev_Katana2_RED
- 128. 12a_Ev_Knife1_GREY
- 129. ScrewDriver



Receive high tension / pressure!
Print these parts at minimum 75% Infill

1f_Ev_Head6_GREY



1d_Ev_Head4_WHITE

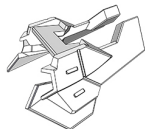

2m_Ev_Chest13_BLACK



2n_Ev_Chest14_BLACK



4b_Ev_Waist2_BLACK



Screw driver

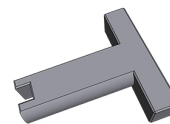

6r_Ev_Leg18_GREY

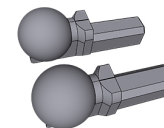



ORIGINAL COPY

TM3D-08 PROJECT EV-01 INSTRUCTION 3

CC BY-NC-ND - Attribution - Non Commercial - No Derivatives
xiaoping zhu | UHEMFTVE | TM3D-UHEMFTVE-20220613210805

1
Head

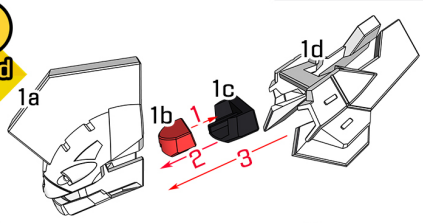

2

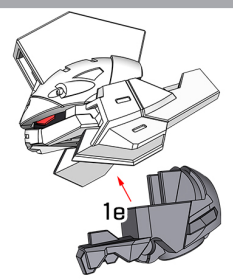

3

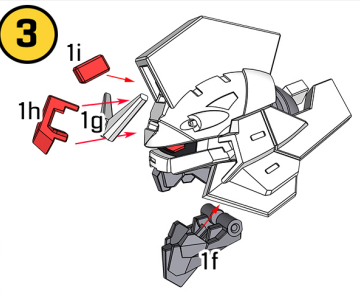

4
Chest

(Left side with "L" mark)
mirror the step
for Right side

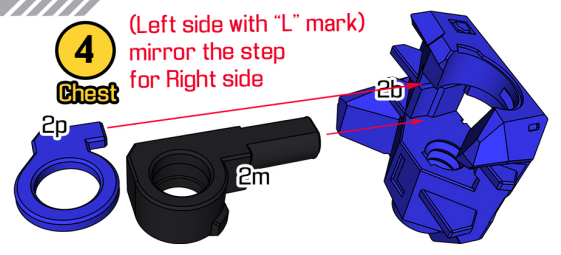

5

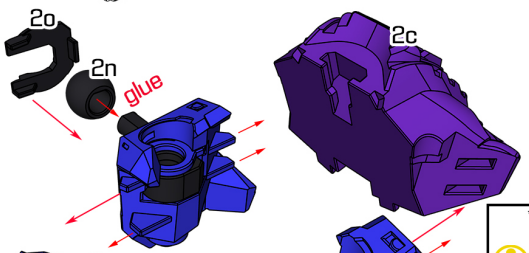

6

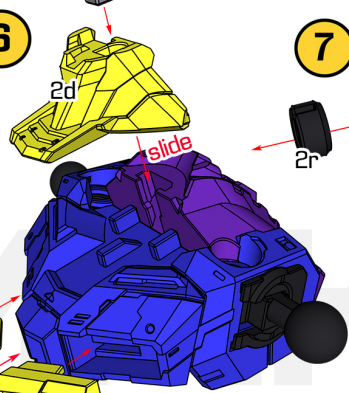

*make sure that the glue is strong enough and not affected by shoulders movement.
Sand 2n with Sand Paper to get maximum smoothness

7

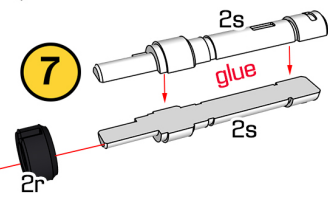

8

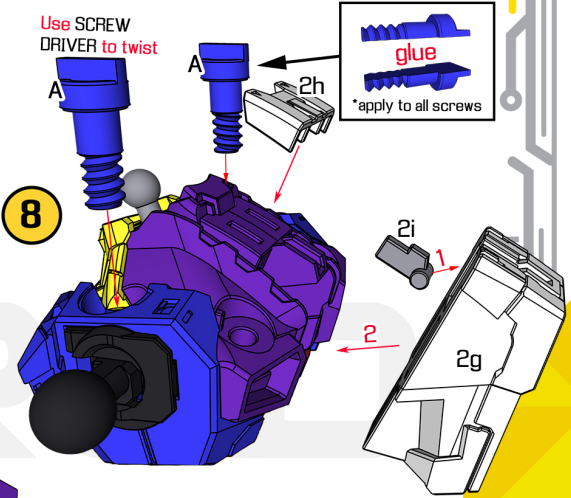

9

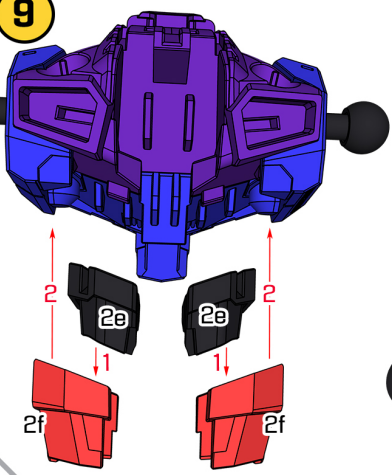

10

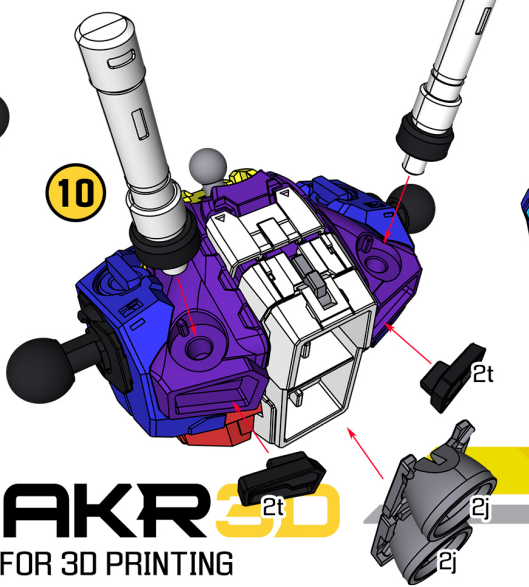

11

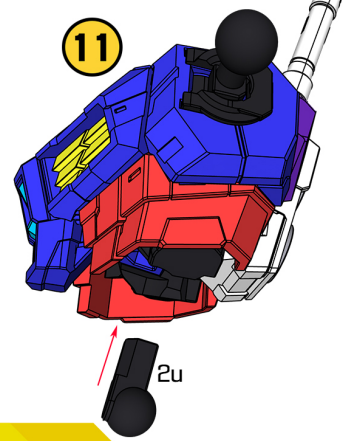

12
Abdomen

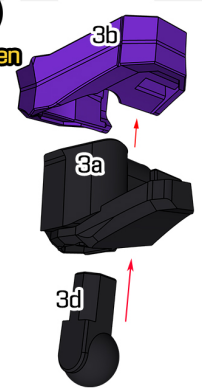

14

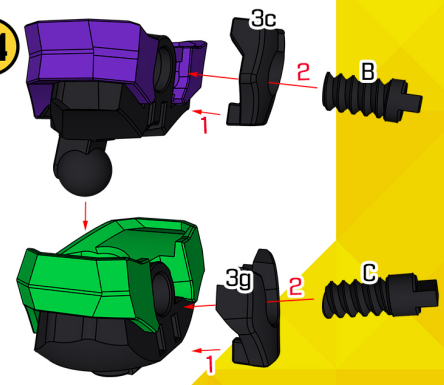

13

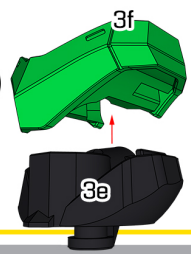



ORIGINAL COPY

TM3D-08 PROJECT EV-01 INSTRUCTION 4

CC BY-NC-ND - Attribution - Non Commercial - No Derivatives
xiaoping zhu | UHEMFTVE | TM3D-UHEMFTVE-20220613210805

15 **Waist**

Slide

16

Slide

17

glue

glue*

18

Slide

19

20 **Leg**

(Left leg with "L" mark) mirror the step for Right leg

21

22

23

24 **Thigh**

H

*make sure that the glue is strong enough and not affected by hips movement
Sand 2n with Sand Paper to get maximum smoothness



ORIGINAL COPY

TM3D-08

PROJECT EV-01

INSTRUCTION 5

CC BY-NC-ND - Attribution - Non Commercial - No Derivatives

xiaoping zhu | UHEMFTVE | TM3D-UHEMFTVE-20220613210805

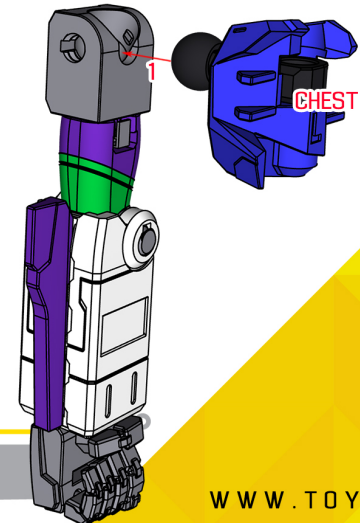
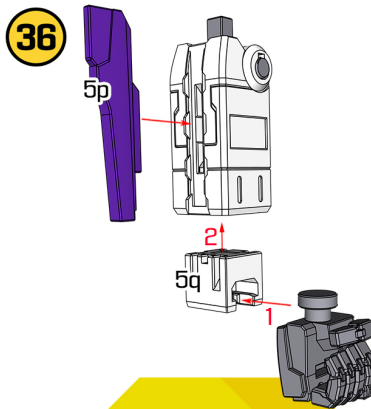
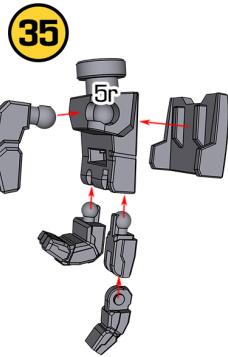
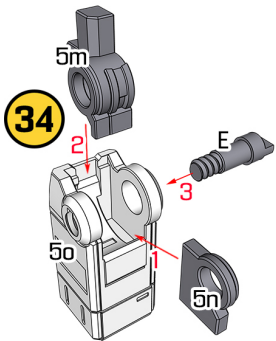
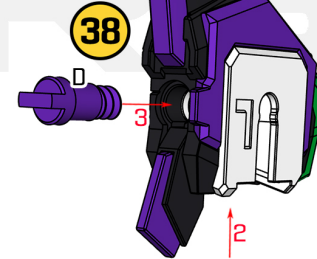
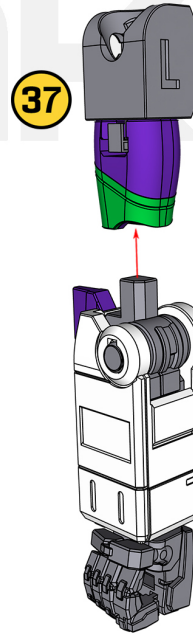
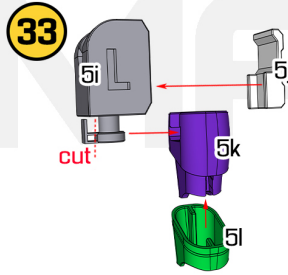
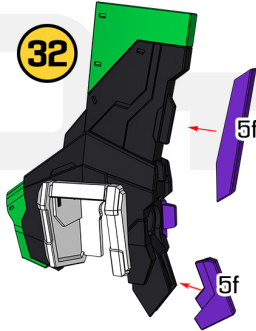
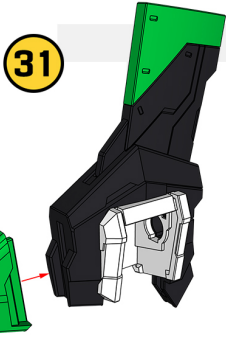
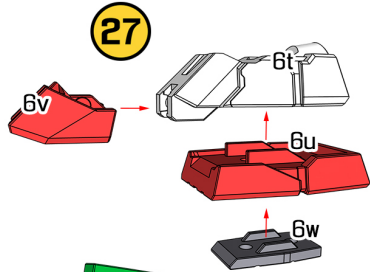
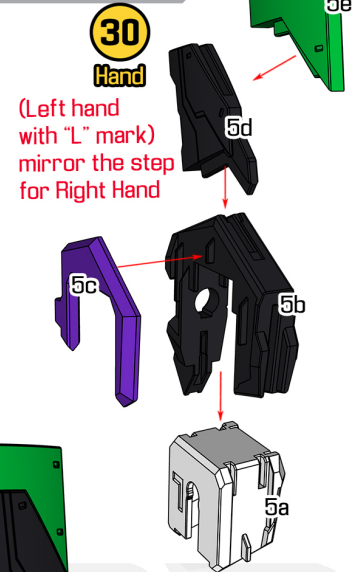
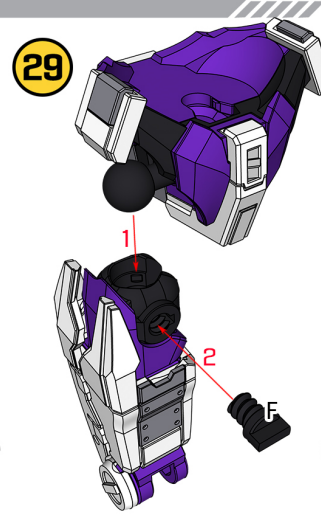
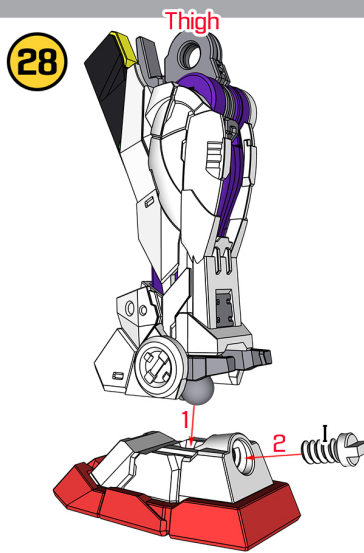
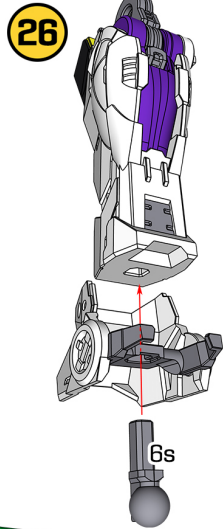
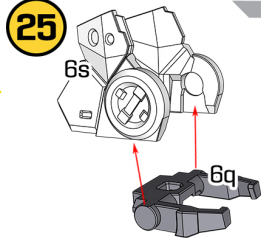



ORIGINAL COPY

TM3D-08 PROJECT EV-01 INSTRUCTION 6

CC BY-NC-ND - Attribution - Non Commercial - No Derivatives
xiaoping zhu | UHEMFTVE | TM3D-UHEMFTVE-20220613210805

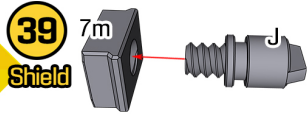

39
Shield

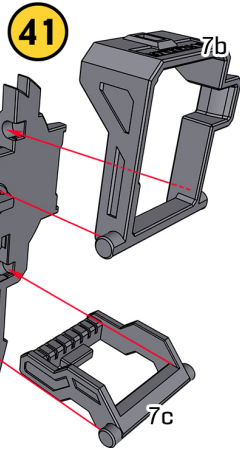

41

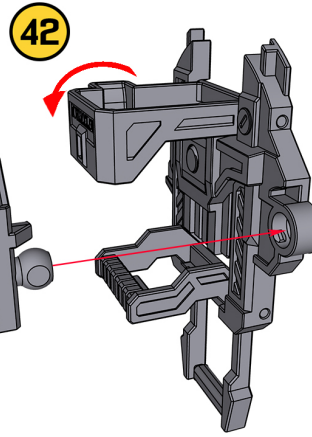

42

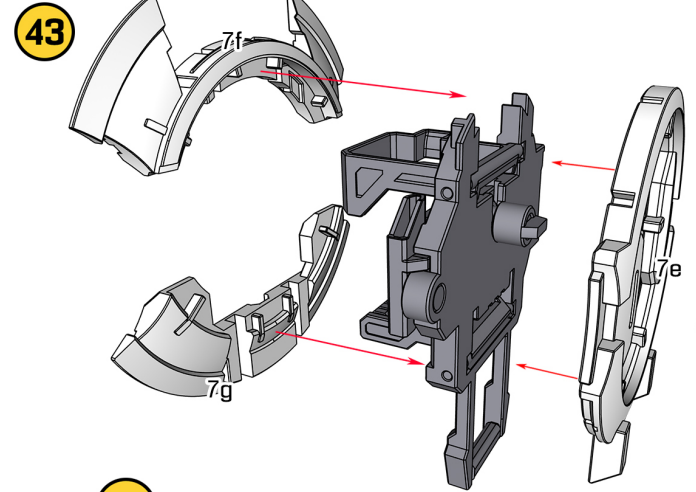

43

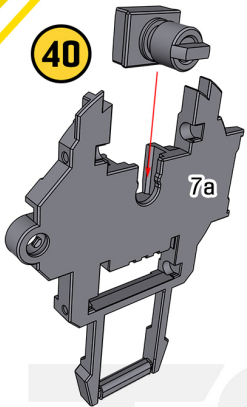

40

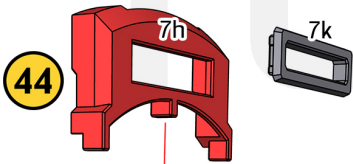

44

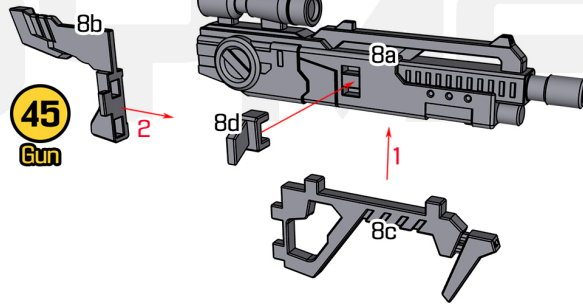

45
Gun

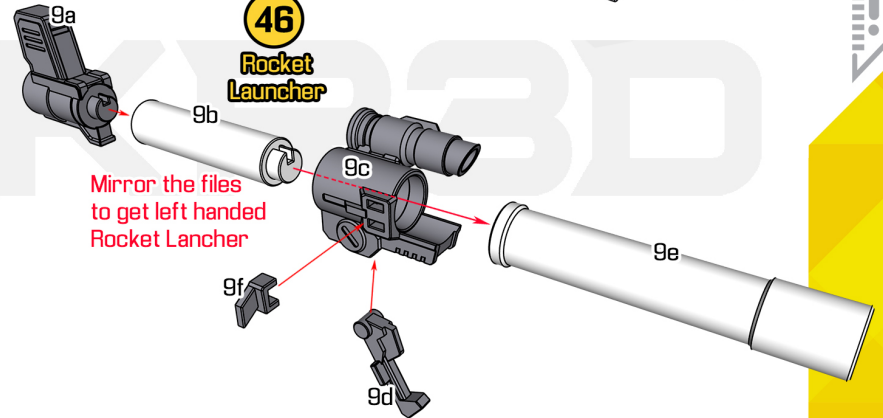

46
Rocket Launcher

Mirror the files to get left handed Rocket Launcher

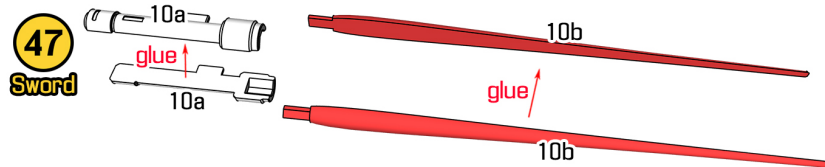

47
Sword

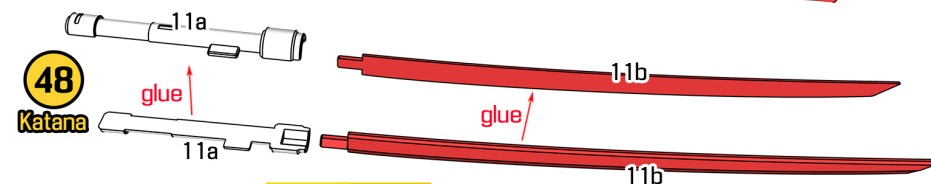

48
Katana

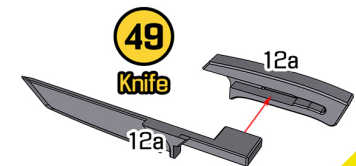

49
Knife

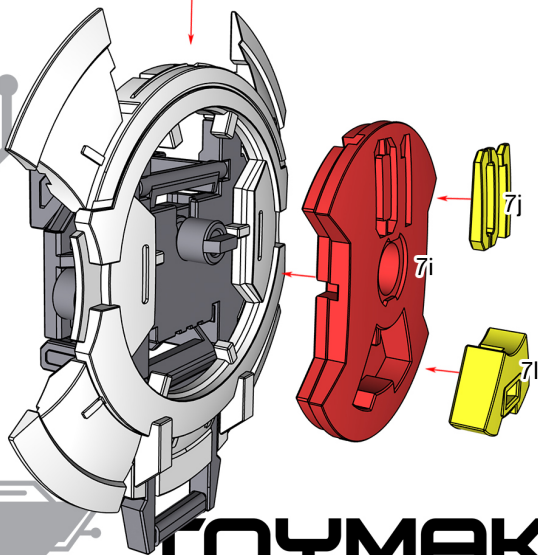



ORIGINAL COPY

TM3D-08

PROJECT EV-01

INSTRUCTION 6

CC BY-NC-ND - Attribution - Non Commercial - No Derivatives

xiaoping zhu | UHEMFTVE | TM3D-UHEMFTVE-20220613210805

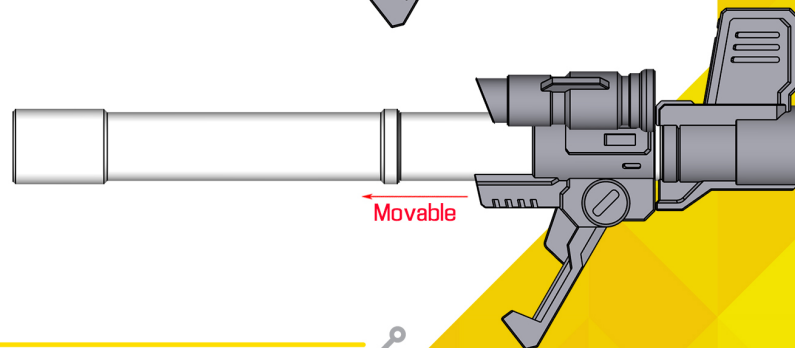
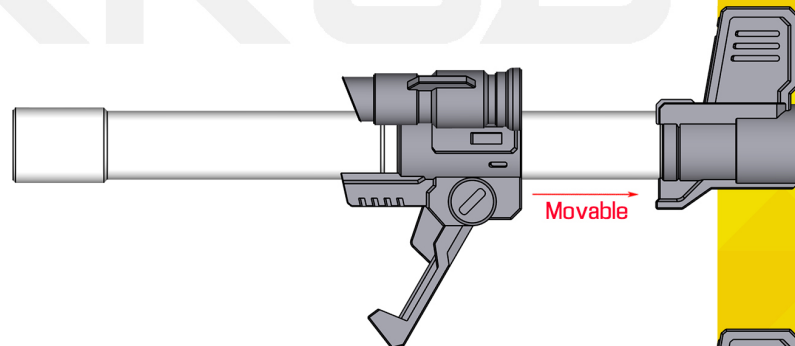
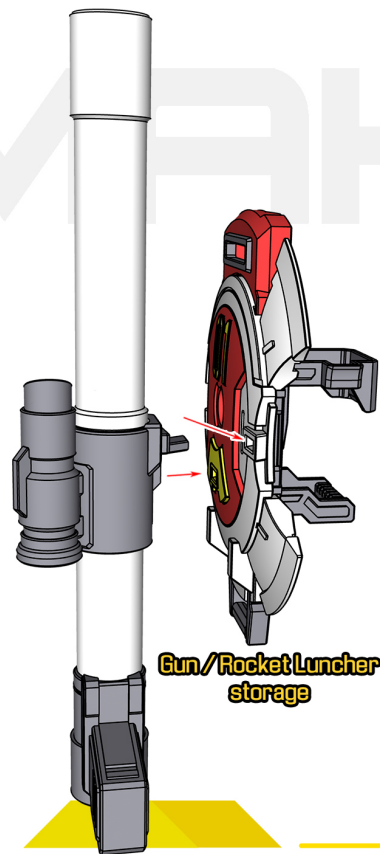
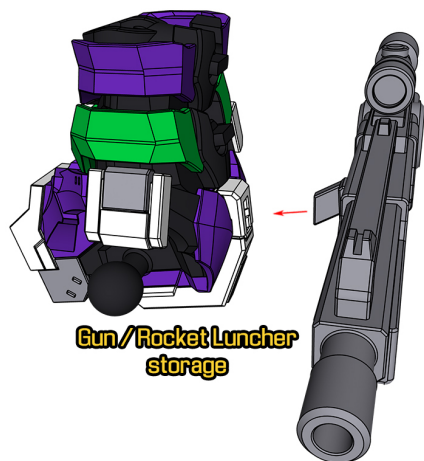
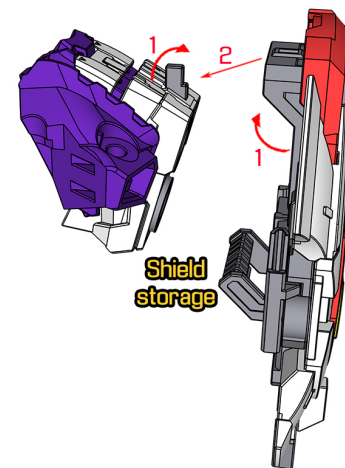
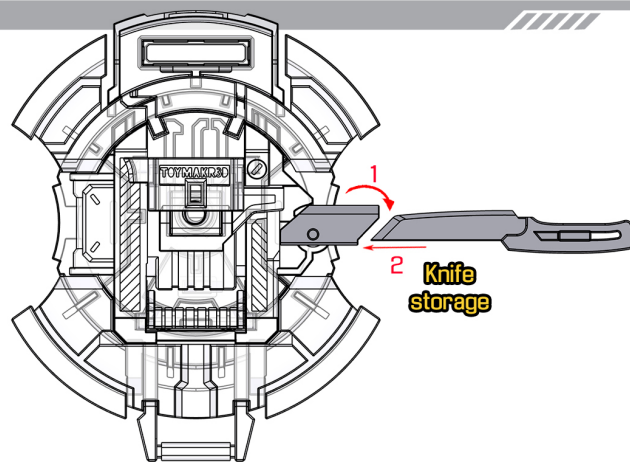
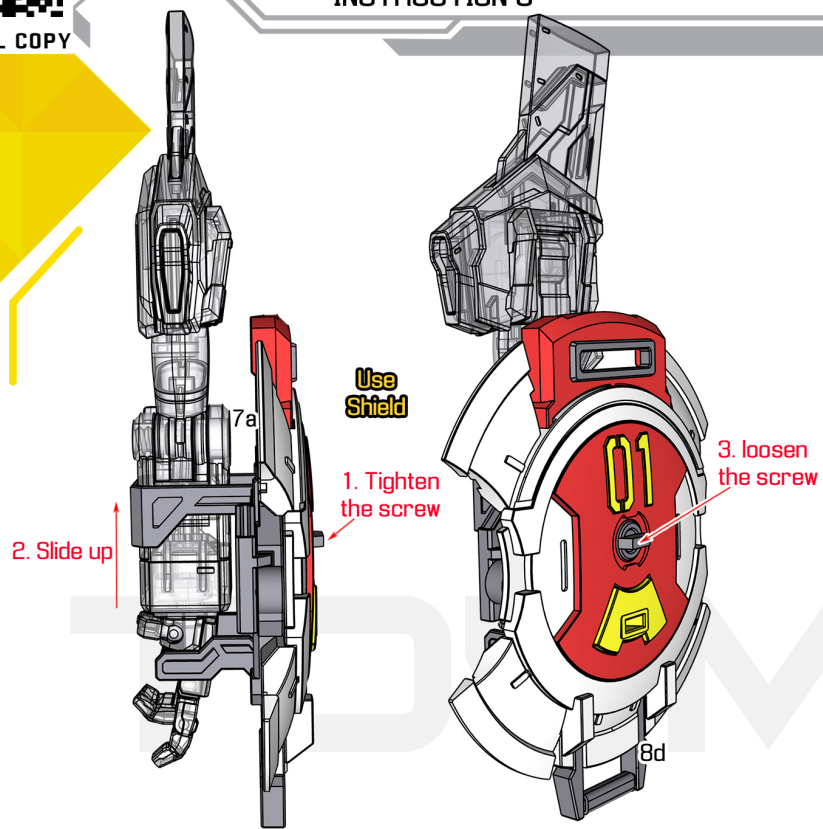

TOYMAKR3D

TOY MAKER FOR 3D PRINTING

WWW.TOYMAKR3D.COM