



Chunkypool Assembly Instructions

Notes About the Assembly

The P#'s refer to plate numbers in the STL files.

Everything is meant to press-fit, so don't be afraid to push hard.

If any of the parts are too tight or loose, simply size them down or up by 0.5-1% and try again. Matte filament works the best.

1 (P1&2)

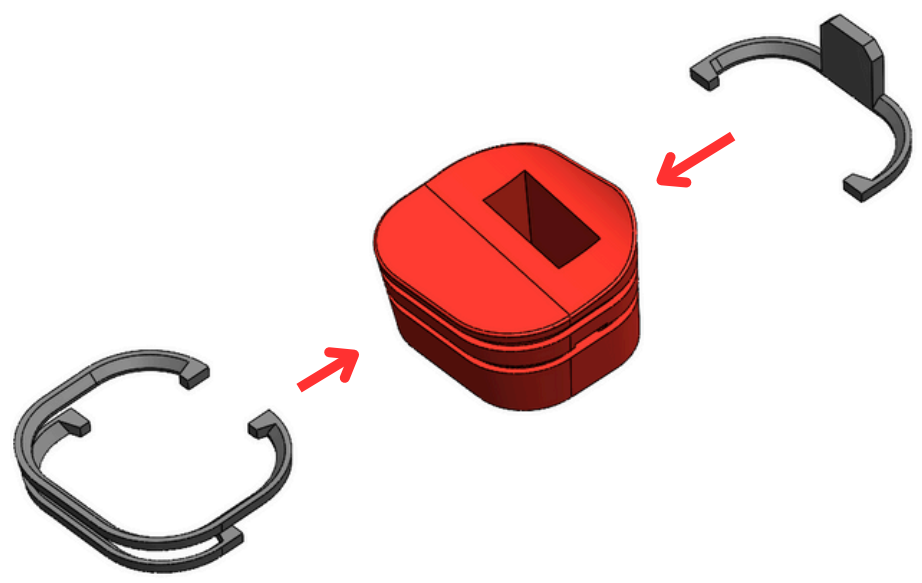

2 (P1&2)

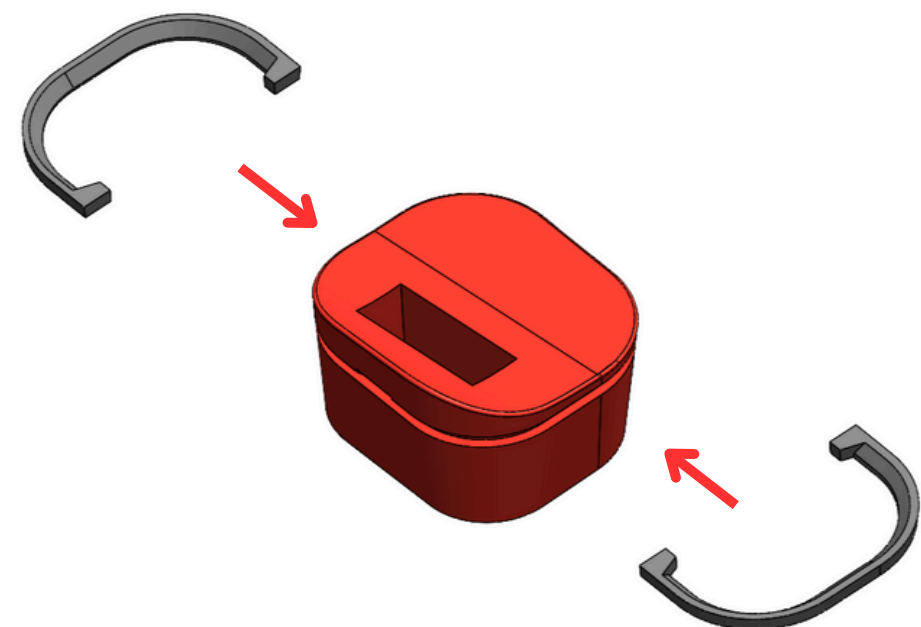

3 (P1&2)

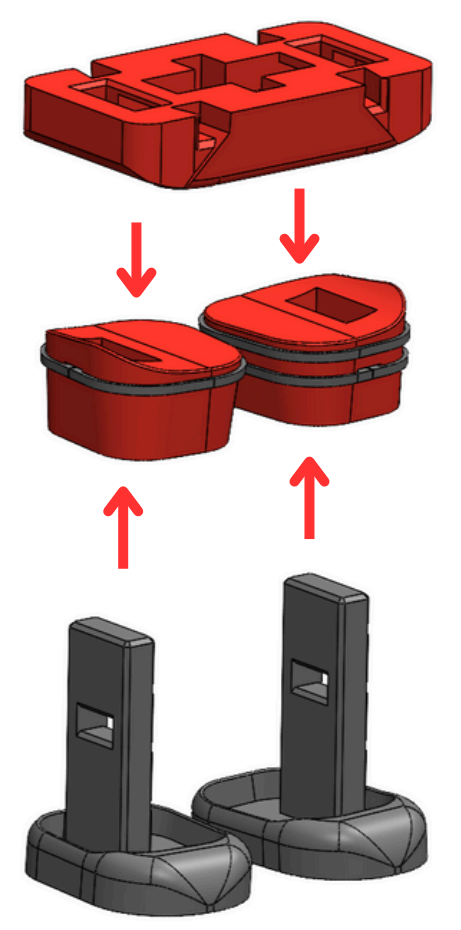

4 (P1)

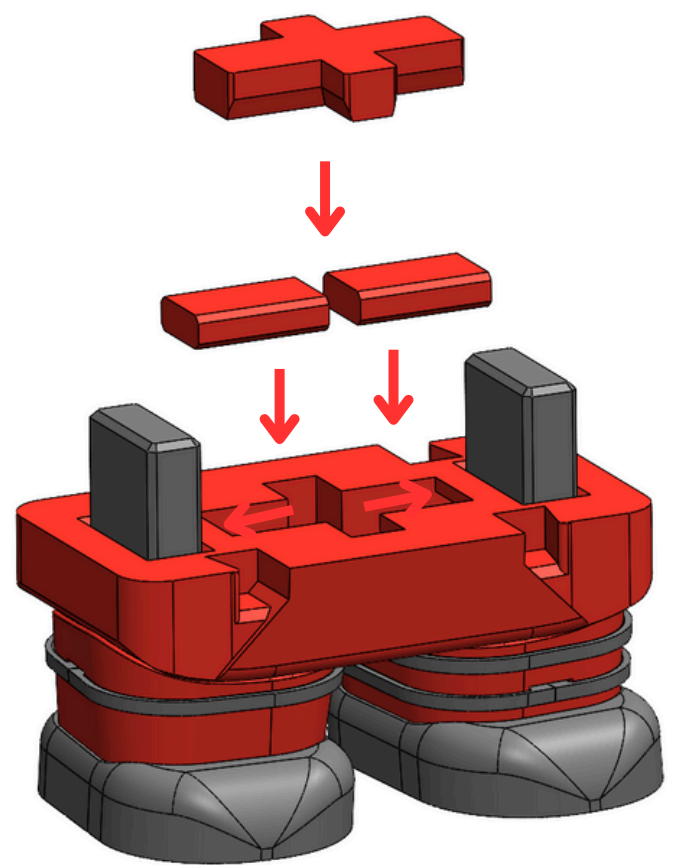

5 (P2)

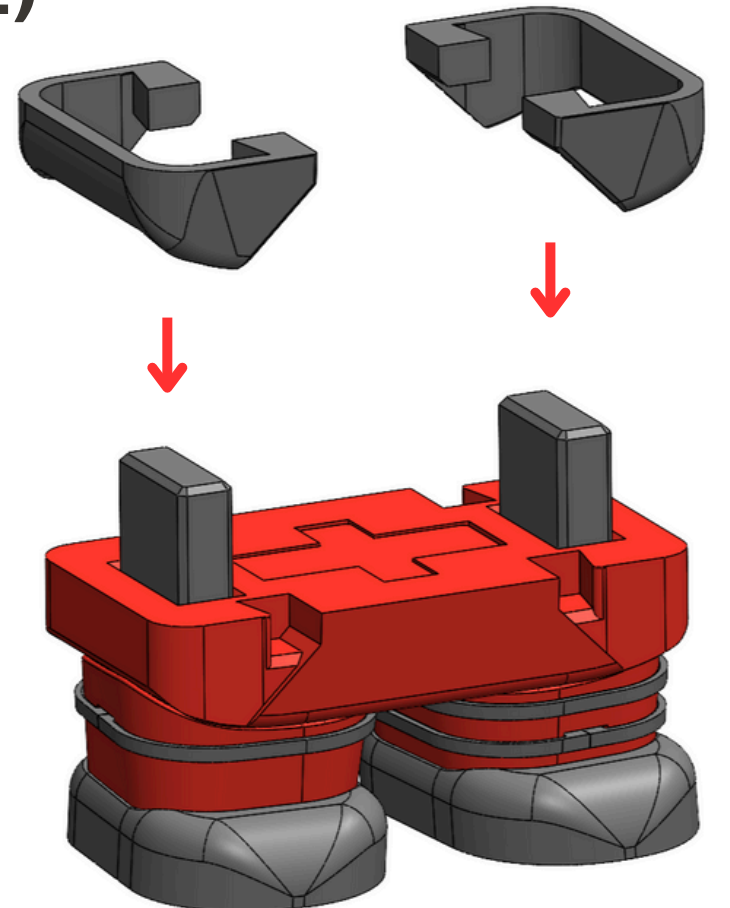

6 (P3)

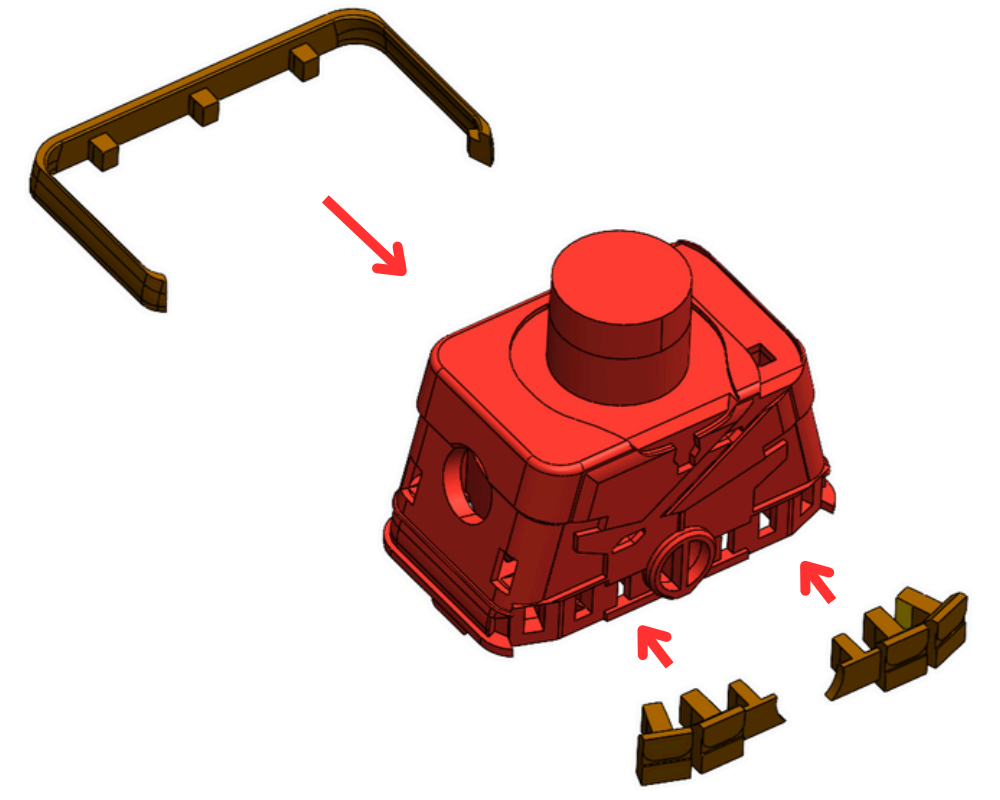

7 (P2)

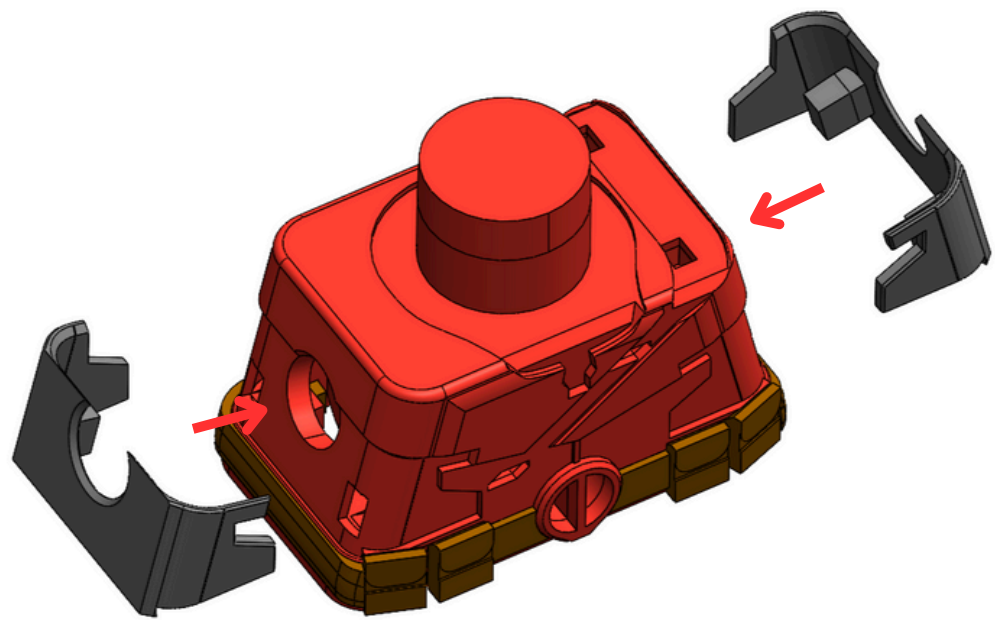

8 (P2&4)

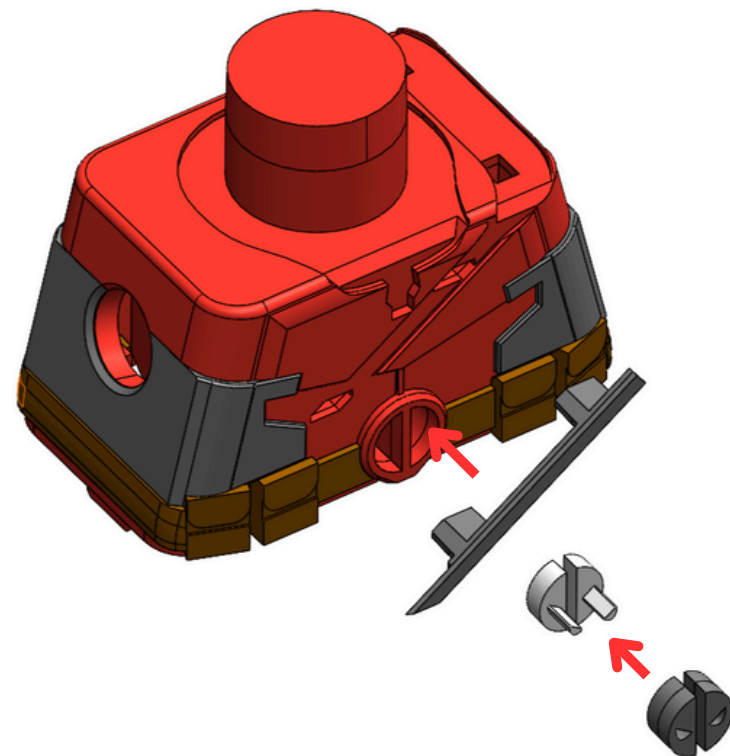

9 (P2)

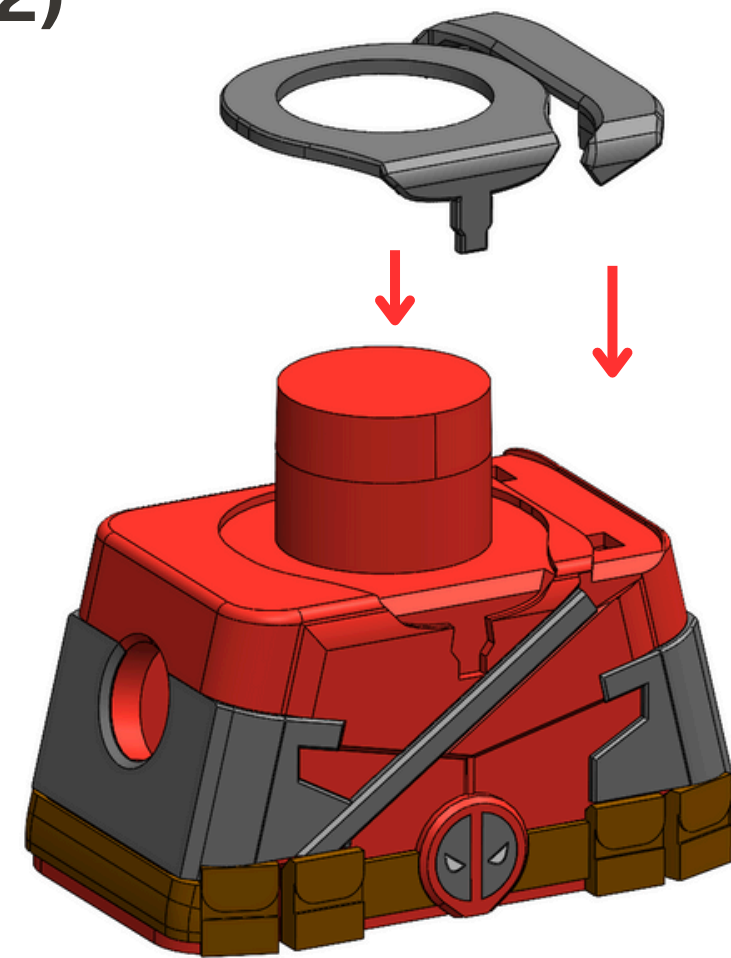

10

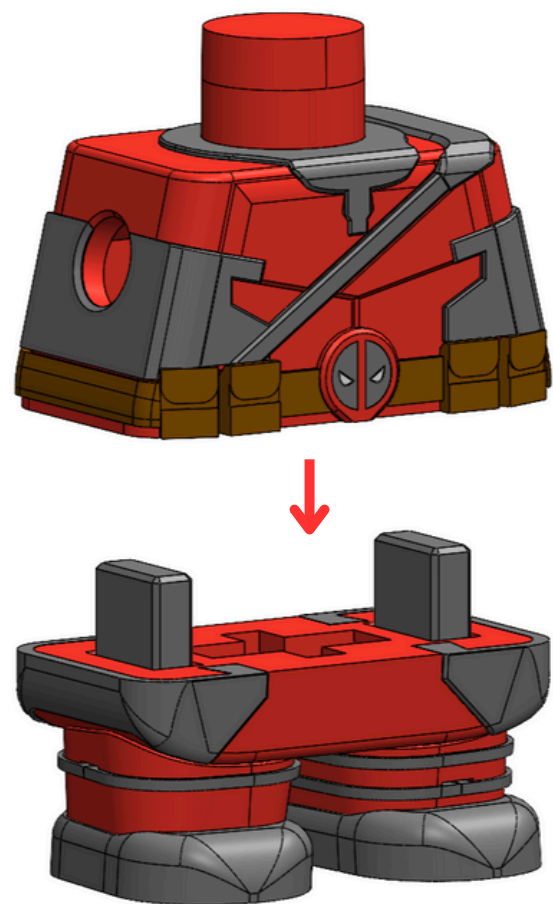

11 (P1&5)

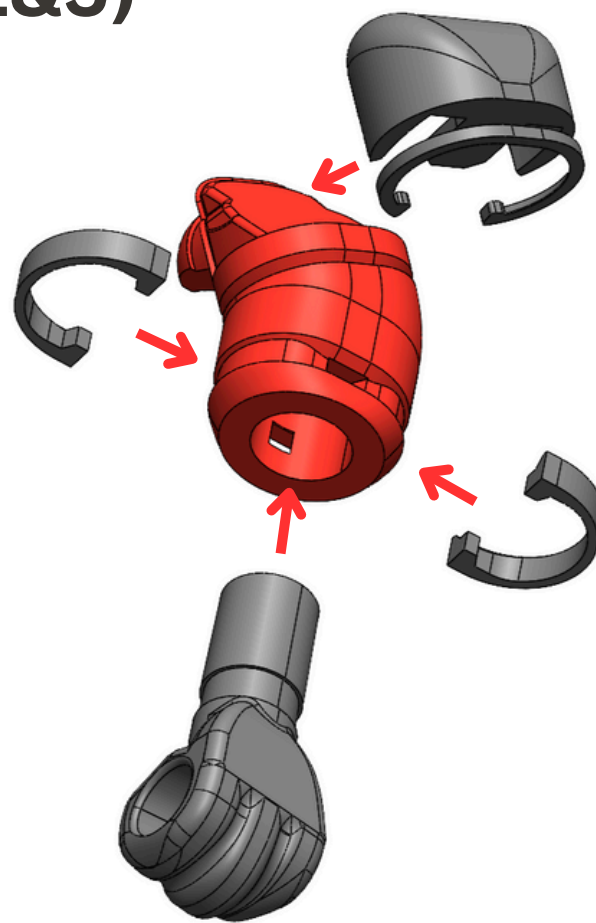

12

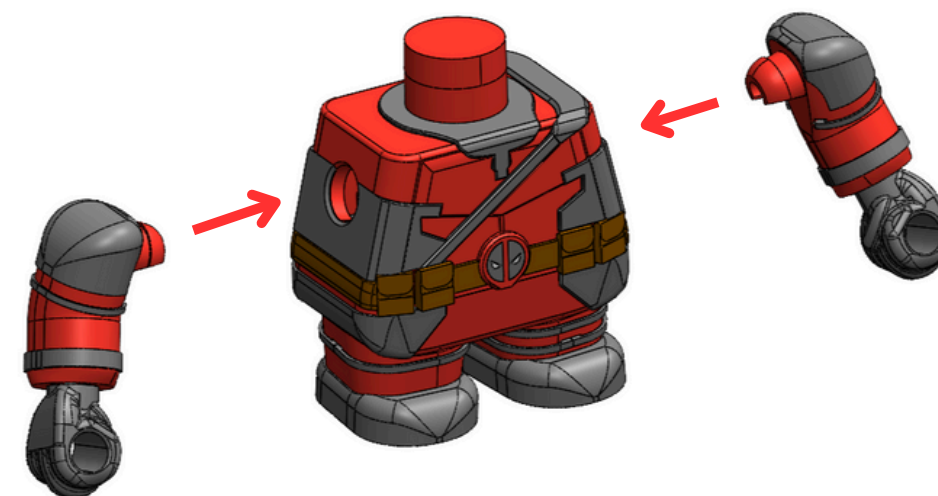

13 (P1,4&5)

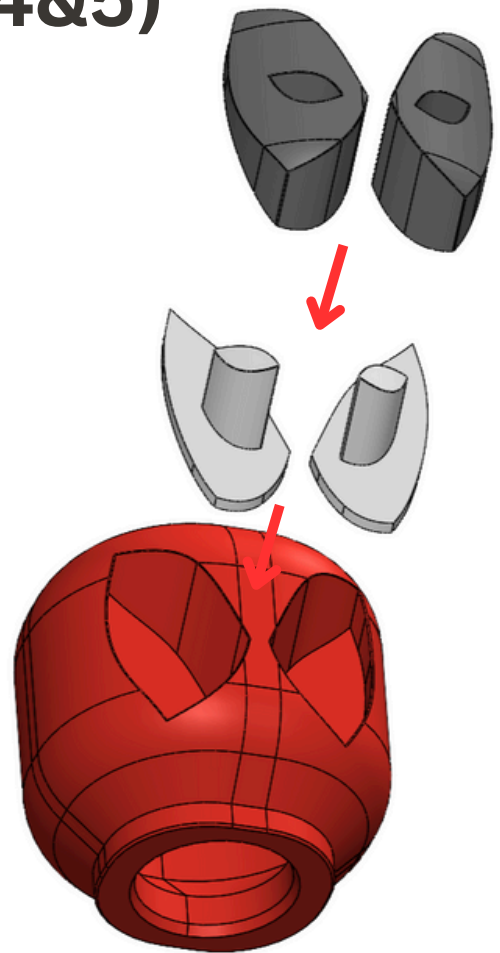

14

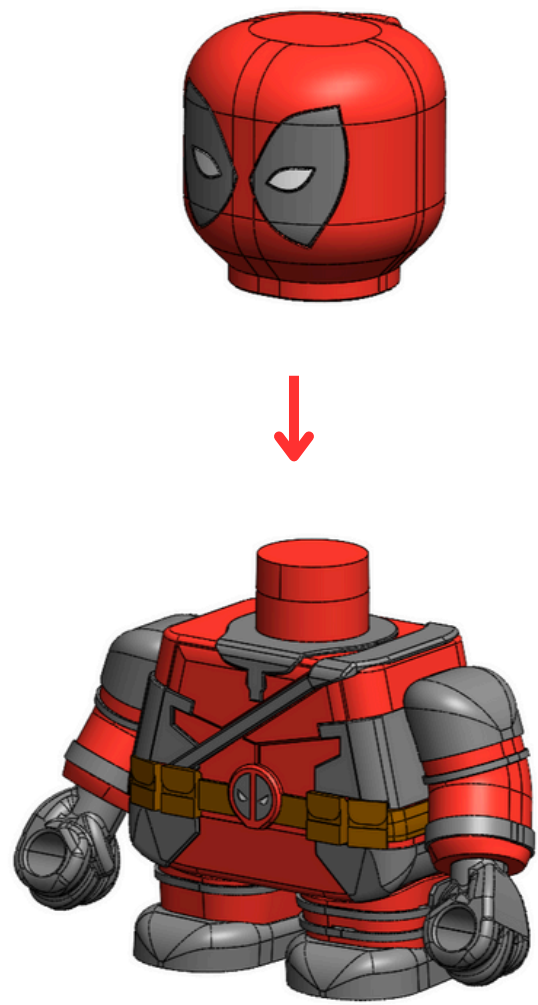

15 (P6)

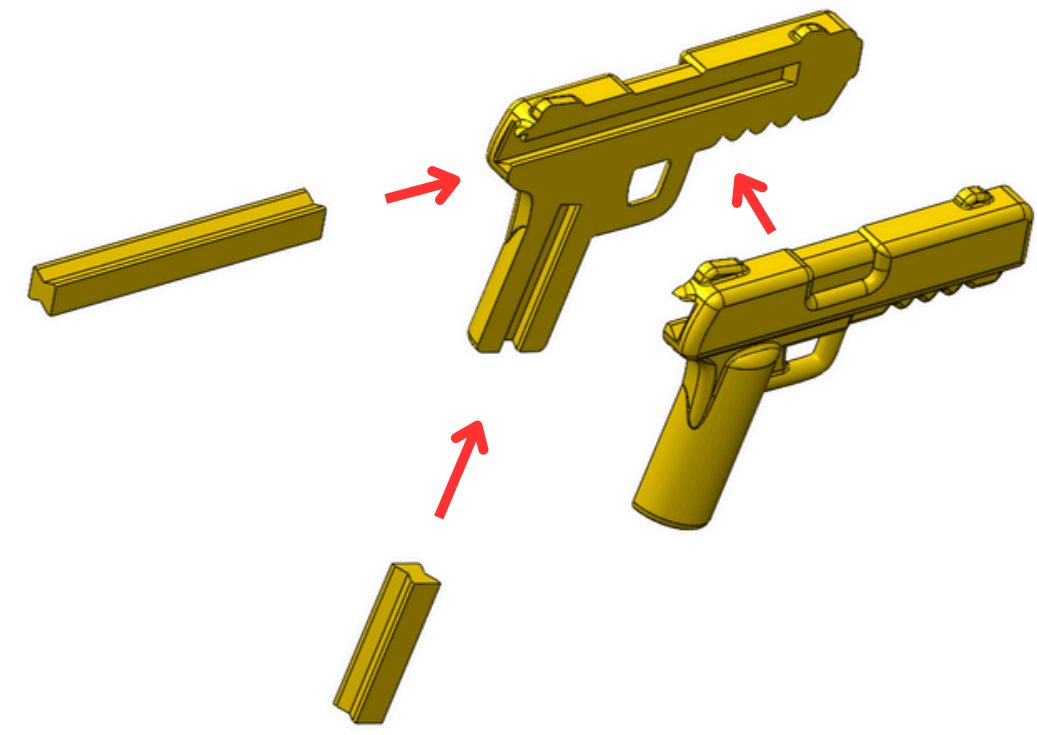

16



17 (P5)

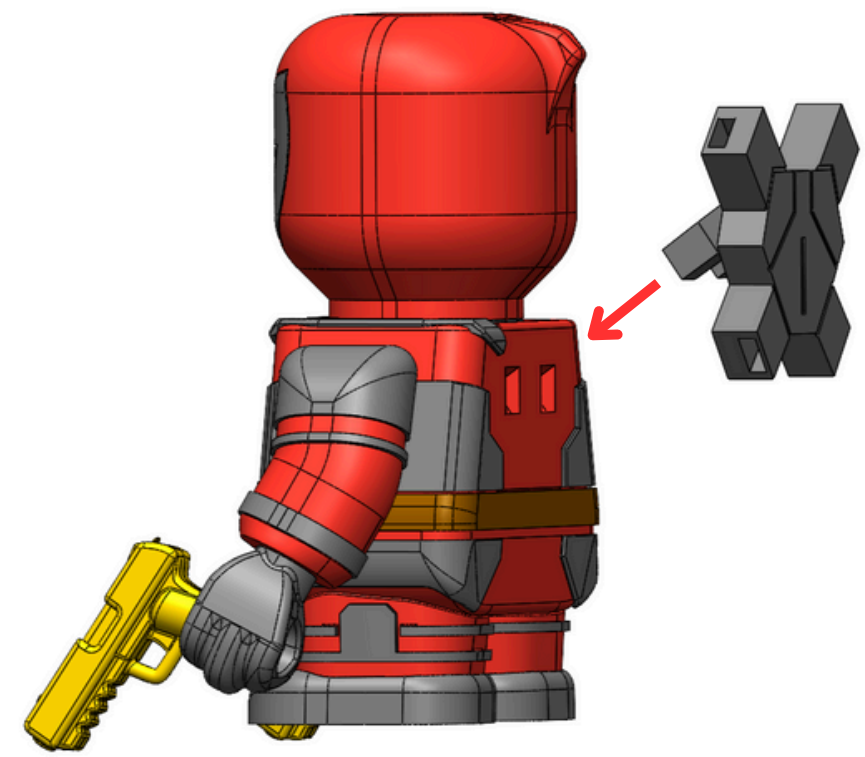

18 (P7)

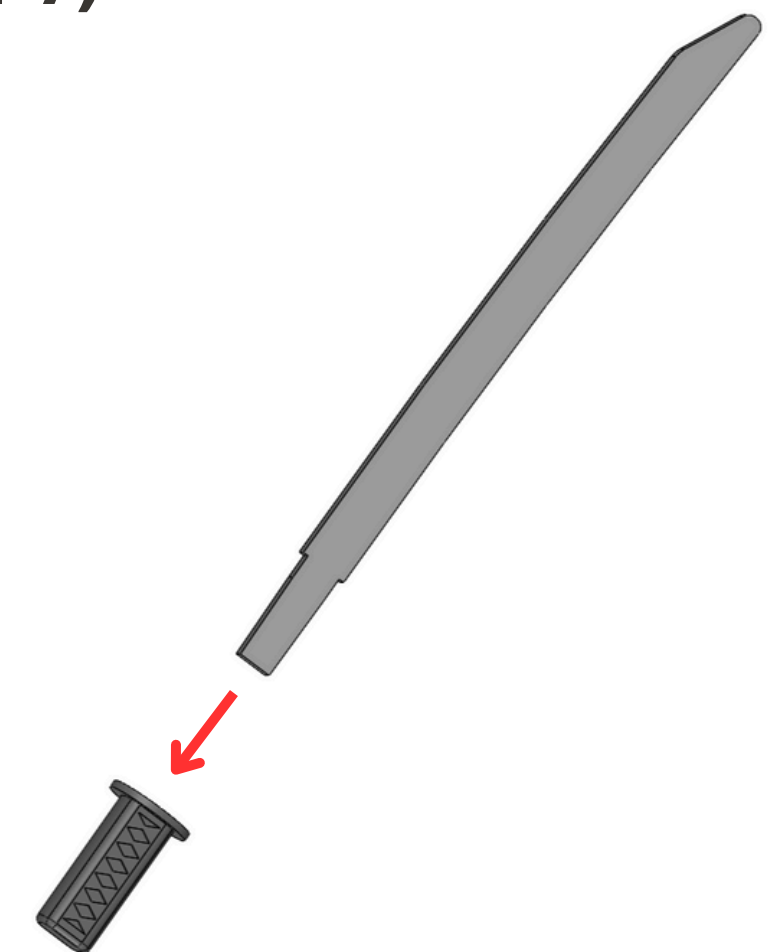

19

